

ORDINANCE NO. 1580

File # 2022020827
BK 4539, PG: 1325 Pages: 1 of 4
Recorded 3/21/2022 2:31 PM
Bill Kinsaul, Clerk, Bay County, FL
Deputy Clerk KM Trans # 1768698

AN ORDINANCE ANNEXING THE FOLLOWING UNINCORPORATED AREA OF BAY COUNTY WHICH IS CONTIGUOUS TO THE CITY OF PANAMA CITY BEACH, FLORIDA, UPON PETITION OF THE OWNER OF SAID PROPERTY; ONE PARCEL LOCATED AT THE NORTH END OF MOONLIGHT BAY DRIVE; PARCEL ID 32735-000-000; SAID PARCEL CONTAINING 3.4009 ACRES MORE OR LESS; REDEFINING THE BOUNDARY LINES OF THE CITY; PROVIDING THAT THIS ORDINANCE SHALL TAKE EFFECT IMMEDIATELY UPON PASSAGE.

WHEREAS, CADH, LLC, owner of real property in an unincorporated area of Bay County which is contiguous to this City, have filed a petition praying that said real property, being more particularly described below, be annexed to this City, and

WHEREAS, the City Council of this City has determined that the petition bears the signatures of all the owners of the property in the area proposed to be annexed, and

WHEREAS, Notice of Voluntary Annexation for this property has been published in the Panama City News-Herald once a week for two (2) consecutive weeks prior to this date, the same being a newspaper of general circulation in this City.

NOW, THEREFORE, BE IT ENACTED BY THE PEOPLE OF THE CITY OF PANAMA CITY BEACH, FLORIDA:

Section 1. It is hereby annexed and made a part of the City of Panama City Beach, Florida, the following described lands in Bay County, Florida, to-wit:

SEE EXHIBIT "A" ATTACHED HERETO

Section 2. The boundary lines of the City of Panama City Beach, Florida, are redefined to include therein said tract of land.

Section 3. A map of the area to be annexed is attached.

Section 4. This ordinance shall take effect immediately upon passage.

PASSED, APPROVED AND ADOPTED at the regular meeting of the City Council of the City of Panama City Beach, Florida, this 10th day of March, 2022.

Mark Sheldon, Mayor

ATTEST:



Lynne Fasone, City Clerk

EXAMINED AND APPROVED by me this 10th day of March, 2022.

Mark Sheldon, Mayor

PUBLISHED in the Panama City News-Herald on the 22nd day of February, 2022, and the 1st day of March, 2022.

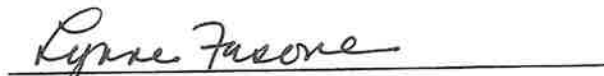
POSTED on pcb.gov.com on the 17th day of February, 2022.

Lynne Fasone, City Clerk

ATTACHMENT TO ORDINANCE NO. 1580

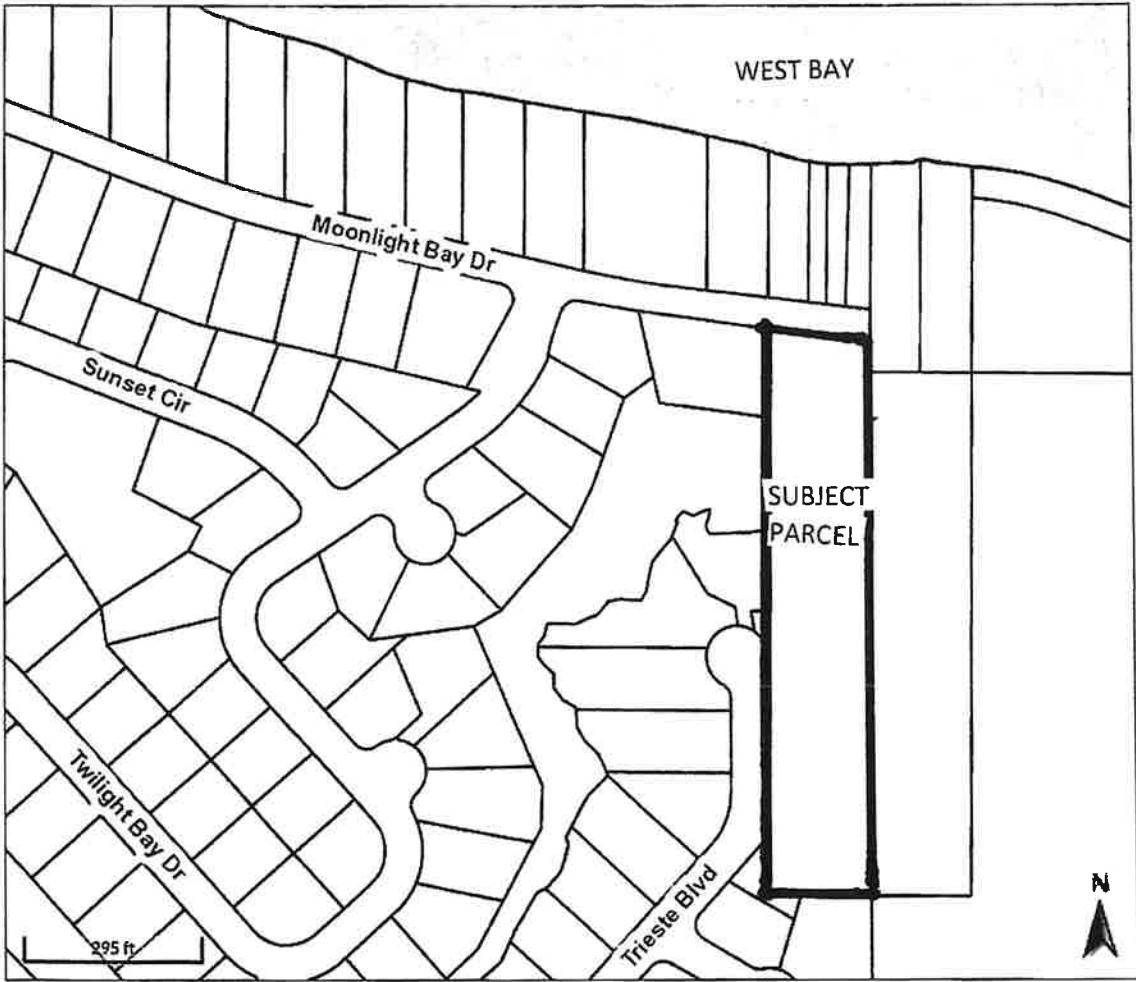

EXHIBIT A

LEGAL DESCRIPTION

COMMENCE AT THE SOUTHEAST CORNER OF THE SOUTHWEST QUARTER OF SECTION 15, TOWNSHIP 3 SOUTH, RANGE 16 WEST BAY COUNTY, FLORIDA; THENCE NORTH 00°33'55" EAST ALONG THE EAST LINE OF SAID SOUTHWEST QUARTER OF SECTION 15 FOR A DISTANCE OF 1319.88 FEET TO THE POINT OF BEGINNING; THENCE NORTH 89°29'10" WEST, ALONG THE NORTH LINE OF LOT 19, TRIEST PHASE 2 PLAT BOOK 21, PAGES 95-111, FOR A DISTANCE OF 164.78 FEET TO THE EAST LINE PARCEL B OF TRIESTE PHASE 2, PLAT BOOK 21 PAGES 95-111; THENCE NORTH 0°32'40" EAST ALONG THE EAST LINE OF SAID TRIESTE PHASE 2 PLAT, FOR A DISTANCE OF 903.71 FEET TO THE SOUTHERLY RIGHT OF WAY EXTENSION OF MOOLIGHT BAY DRIVE; THENCE SOUTH 83°17'38" EAST ALONG SAID RIGHT OF WAY LINE FOR A DISTANCE OF 166.40 FEET TO THE EAST LINE OF THE SOUTHWEST QUARTER OF AFOREMENTIONED SECTION 15; THENCE SOUTH 00°35'14" WEST LONG SAID EAST LINE FOR A DISTANCE OF 885.61 FEET TO THE POINT OF BEGINNING. SAID LANDS CONTAINING 3.4009 ACRES, MORE OR LESS.