

RESOLUTION NO. 24-122

A RESOLUTION OF THE CITY OF PANAMA CITY BEACH, FLORIDA, AUTHORIZING THE CITY TO NEGOTIATE A CONTRACT WITH NEW LINE SKATEPARKS FL, INC. FOR DESIGN-BUILD SERVICES FOR A SKATE PARK LOCATED AT FRANK BROWN PARK.

WHEREAS, the City has solicited statements of qualifications from firms seeking a qualified, experienced, and licensed Design-Build Firm to design and build a skate park at Frank Brown Park (PCB24-25 RFQ); and

WHEREAS, three firms responded to the RFQ; and

WHEREAS, a five-member evaluation committee individually reviewed the statements of qualifications and found all to be responsive; and

WHEREAS, based on the evaluations of the statements of qualifications, the committee ranked New Line Skateparks FL, Inc. No. 1 for the purpose of engaging in contractual negotiations for Skate Park Design-Build services.

BE IT RESOLVED that the appropriate officers of the City are authorized and directed to attempt to negotiate a Contract for Skate Park Design-Build Services with New Line Skateparks FL, Inc. in the following order of ranking:

First - New Line Skateparks FL, Inc.
Second - Spohn Ranch, Inc.
Third - ECSC, LLC with Team Pain Skateparks

and to return the negotiated Contract to the City Council for approval.

THIS RESOLUTION shall be effective immediately upon passage.

PASSED, APPROVED AND ADOPTED in regular session this 11th day of April, 2024.

CITY OF PANAMA CITY BEACH, FLORIDA

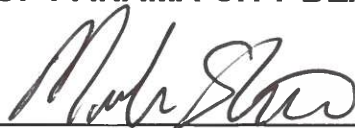
By: 
Mark Sheldon, Mayor

ATTEST:

Lynne Fasone, MMC, City Clerk



CITY OF PANAMA CITY BEACH

RFQ PCB 25-25: SKATEPARK
DESIGN-BUILD SERVICES



NEWLINE
SKATEPARKS

NEW LINE SKATEPARKS FL, INC
#1, 137 WEST MARION AVE, EDGEWATER FL, 32132
T 1.866.463.9546 F 604.530.1119
WWW.NEWLINESKATEPARKS.COM
INFO@NEWLINESKATEPARKS.COM

MARCH 13th, 2024



TABLE OF CONTENTS

EXECUTIVE SUMMARY

Executive Summary	1
Firm Qualifications and Experience	4
Organizational Profile and Staff Design-Build Qualifications	28
Approach to Scope of Work	36
Project Understanding (36)	
Our Approach (38)	
1. Community Consultation (38)	
2. Design Development Considerations (40)	
3. Technical Design and Working Drawings (50)	
4. Construction (51)	
5. Overall Quality Control (Schedule and Budget Control) (55)	
6. Warranty and Post Occupancy Support (56)	
Proposed Methodology and Project Schedule (58)	
Sample/Preliminary Design Directions (attached at end of section)	
Knowledge of Site and Local Conditions	66
References	67
Minority Participation	68
Subconsultant / Subcontractor Information	69
Financial Resources	75
Legal Proceedings and Performance	75
Required Forms	Attached Separately

RE: PCB25-25 RFQ - SKATEPARK DESIGN-BUILD SERVICES

Thank you for considering our team for modern skatepark development assistance. We believe this project will be an excellent investment in the youth and families of Panama City Beach and a welcome addition to the community.

We are pleased to submit our proposal for design-build services. New Line Skateparks FL, Inc (Lead Designer, Professional Engineer and General Contractor) is proud to offer a unique combination of focused local resources and internationally renowned skatepark development expertise capable of addressing the full suite of needs for this project, its stakeholders and the City of Panama City Beach (CPBC). While our skatepark experience spans 23+ years, 4 continents and more than 450 projects, our 'heart' and focus remains in Florida, where our team lives, works and plays. We have been careful to monitor our company growth and workload over the last two decades and offer our full confirmation that our team (~75 full time staff) has the availability, licensure/certifications, and specialized resources required to execute this special community project within the important design-build parameters outlined. In short, this project will have the full breadth of our capabilities, experience and passion!

For the project at hand, we are excited about the prospect of employing our unique skill, experience, and resources as a proven team to deliver significant efficiencies and unsurpassed quality throughout the development process. With our pioneering work on many of the world's most recognized concrete youth park facilities, coupled with our extensive skatepark design and construction work in the area (*most recently our design-build of the Downtown Panama City Skatepark*), we will approach this project with exceptional understanding and a heightened ability to navigate through the community outreach process, technical issues, municipal protocol, and local construction environment. While still preserving meaningful opportunities for local suppliers to participate in non-specialty construction scopes, *Our team will self-perform all key skatepark design, engineering and specialty concrete construction undertakings, and serve as the single point of accountability for the CPBC - ensuring full design continuity and complete quality + cost control throughout all phases of the project.*

Within this RFP submission you will find detailed information about our team including our previous project experience, key staff, proposed approach and value-added offerings. We are aware of this project's unique site and important community engagement considerations, and are excited about the prospect of delivering a highly integrated and accessible "all wheel" skatepark environment that will truly enhance Frank Brown Park and serve as a celebrated destination for Panama City Beach youth, families and visitors from across the region.

Please see the following two pages for specific information related to our corporate structure, history and State licenses. Upon review of our entire submission, don't hesitate to contact us should you have any questions or comments. Our team is prepared to begin work immediately and will proceed through each project phase upon approval from CPBC.

Sincerely,

Kyle Blon
 President and Primary Contact - New Line Skateparks FL, Inc
 #1, 137 West Marion Ave, Edgewater FL, 32132 (US Head Office)
 T 1 866 463 9546 F 604 530 1119
 info@newlineskateparks.com
 Support Offices: San Diego CA, Langley BC



CORPORATE INFORMATION

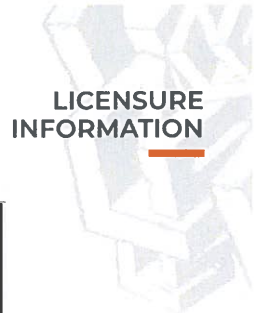

LICENSURE INFORMATION



New Line Skateparks FL, Inc
 (Contracting Entity For Project at Hand)
 Year Incorporated: 2017
 State Incorporated: Florida
 President: Kyle Dion

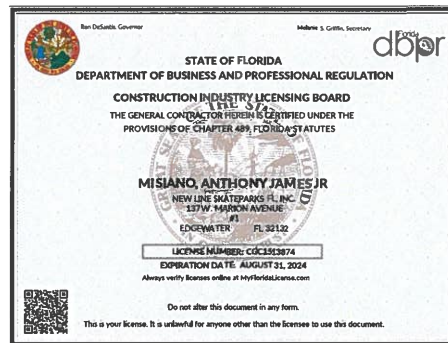

General Contractor License
 License #: GC1513874
 Licensed Since: 2017
 License Expiry: Aug 31, 2024



CERTIFICATE OF INCORPORATION

I Herby Certify that
NEW LINE SKATEPARKS INC.
 has this day been incorporated under the Company Act

New Line Skateparks, Inc
 (Parent Corp)
 Year Incorporated: 2001
 State Incorporated: British Columbia
 President: Kyle Dion



State of Florida

Board of Professional Engineers

Andrew Graham Stone
 has shown engineering and fitness to practice Professional Engineering and has completed such all requirements of the Board of Professional Engineers. Therefore by action of the governing board in and consent of the State of Florida, the Florida Board of Professional Engineers hereby issues this certificate of licensure numbered 96794 in practice Professional Engineering in the State of Florida as provided by the laws of the state and subject to the powers as vested in said Board.

Florida Engineering License
 (Andrew Stone - Staff Engineer)
 License #: 96794
 License Expiry: July 7, 2025



FIRM QUALIFICATIONS AND EXPERIENCE





ABOUT US

Let Us Introduce Ourselves

New Line Skateparks is North America's Premier Skatepark Development Firm. With over 450 highly recognized projects around the world, we are proud to serve as one of the Nation's longest running and most experienced concrete youth park design-build teams.

Our staff (approx 75) is comprised of registered landscape architects, engineers, planning experts, and construction professionals who are passionate active skateboarders. This passion inspires us to deliver cutting edge designs and authentic finished environments that create a meaningful connection between youth and the communities in which they live.

We love what we do. When we engage a community in the development process we bring a professional, organized and fun attitude. The design journey is important and our approach is inclusive. We spare no resource to ensure youth and affected stakeholders truly become part of each project solution.



NE Community Park Skatepark
Frisco, TX

American Shotcrete Association
Outstanding Shotcrete Award
Texas Recreation and Parks
Association
Excellence In Design Award



What We Believe

New Line Skateparks is committed to the improvement of natural and built environments for all generations. Our goal is to promote environmental quality as a way to protect what we value in our unique region. Through listening, watching and testing ideas, we create youth park solutions that work in harmony with existing environments and ultimately lead to fully integrated places.

Skateparks are changing. The days of the stereotypical 'grey square' have long passed as a new era of concrete facility design responds to far more than purely function. When designed and constructed with strong community input and sensitivity to the surrounding context, skateparks not only become beloved destinations for local youth but celebrated public spaces for all to enjoy!

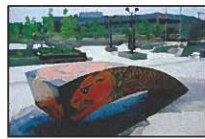

Plaza at the Forks, Winnipeg, MB

"The quality of the design is demonstrated by the international recognition the Plaza received from the skateboarding community. The Plaza at the Forks sets the bar for other cities throughout North America which are struggling to respond to similar issues."
- CSLA Jury Comments

Canadian Society of Landscape
Architects
National Honor Award
Skaters for Public Skateparks
Public Space Award



Services... The Art of Shaping Space

Master Planning and Feasibility Studies - NLS provides planning expertise to municipal governments for action sports networks as well as individual project developments. Through completing the award winning Calgary Skateboarding Amenities Strategy, as well as Skateboarding/Action Sports Master Plans for Lethbridge AB, Arlington TX, Port Coquitlam BC, and Waterloo ON, we have established a proven, transparent and credible planning process that has been widely recognized as a benchmark for our industry. Whether it be site selection, feasibility studies, fundraising programs, or long term facility development strategies, we strive to offer the best mix of qualified personnel and specialized resources for each unique planning challenge.

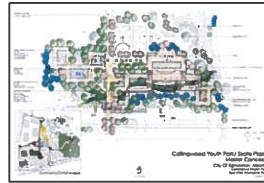

Callington
Youth Park
Concept Master Plan
Edmonton, AB

Site Selection Boards
Brantford, ON

Public Consultation - NLS provides comprehensive consultation services to facilitate community input in the design of Skateparks and other progressive public spaces. As passionate skateboarders and avid park users ourselves, we know how important participation by youth and other members of the community will be to the long term success of each project. No matter what project size, we deliver a tailored program of hands-on, interactive design workshops and public presentations facilitated by principal members of our team. Outside of our scheduled meetings, youth and other stakeholders are encouraged to continue to submit written comments, sketches, pictures etc. through our specially developed custom web survey for immediate and ongoing feedback. Overall, we believe engaging the community in a meaningful way is one of the most critical aspects of any skatepark design journey and a key factor to our team's continued success.

1st design workshop - Panama City, FL
Pre-construction community info session - Seattle, WA



City of Vancouver Skateboarding
Amenities Strategy

CSLA
National Honor Award





Services... The Art of Shaping Space

Design - NLS designs award winning municipal concrete skateparks and other wheeled sport environments that continually set the bar for international skatepark and pump track development. From day one, we have chosen to think outside the 'concrete square' by leading the industry in introducing a site and community-specific design approach, integrated art/sculptural installations, green/sustainable development initiatives, CPTED principles, innovative materials and aesthetic detailing, progressive lighting schemes, skateable donor recognition signage, and architecturally striking skatepark roof structures. We believe that every project and community has a unique 'story' that can be told through authentic and enduring skatepark architecture. To realize our unique designs, we take great pride in delivering photorealistic 3D facility modeling, animated project 'fly-through' experiences, and certified technical drawings to ensure complete project understanding and a thorough construction process for each park.

Construction - New Line Skateparks is one of North America's most experienced providers of large-scale municipal skatepark construction services - serving as the General Contractor on a significant portion of the 450+ designs completed by our team. Whether it be complete turnkey project solutions or specialty services/products, we are recognized as a global leader in the development of site-built concrete skatepark construction technology and techniques. Our team has also worked hard to lead the industry in cost and schedule control, safety, and concrete quality accreditation - with a guarantee of design-build budget certainty, on-time project performance, and ACI (American Concrete Institute) certified team members overseeing all shotcrete operations. Finally, New Line Skateparks has been fully bonded and insured for over 23 years and employs approximately 40 dedicated field staff leading municipal skatepark projects across the world.

American Shotcrete Association
Outstanding Shotcrete Awards
 NE Community Skatepark - Frisco, TX + Norton Skatepark - Burlington, ON



C.J. Smith Skate Plaza - Newnan, GA



Seattle Center Skate Plaza - Seattle, WA



Bonita Springs Skatepark - Bonita Springs, FL



Centennial Park, Greeley, CO



Vancouver Skate Plaza - CSLA Regional Honour Award



Roc City Skate Plaza - Rochester, NY - American Public Works Association Excellence in Design Award



Manna Park Skate Plaza - Thunder Bay, ON - Parks and Recreation Ontario Excellence in Design Award

Youth Park Design Philosophy...

New Line Skateparks Inc. has worked extensively in the planning, design and construction of concrete skateparks, pump tracks, BMX parks, mountain bike courses and other progressive 'casual recreation' facilities. Although this emerging area of recreation is not new, the participation levels associated with inline, BMX, mountain biking and skateboarding have climbed to exceptional levels over the last 20 years.

Youth Park Design Philosophy...

The inclusion of 'Action Sports' in the planning process benefits the whole community by making children, youth and adults that participate in these activities feel valued. Developing a youth park strategy that includes action sports programs and facilities will introduce new experiences and challenges for a broad demographic that is often difficult to engage and/or overlooked in community parks planning.

Youth Park Design Philosophy...

Developing a successful youth park design requires a consultant to think and act in a way that respects the desires of future park users. This respect must be balanced with an understanding of construction tolerances, safety standards, community needs, security, and budget. NLS has a diverse and qualified staff who consistently seek new ways to achieve the expectations of the target user group while setting realistic goals, limits and deadlines.



'UNIQUELY NEW LINE' + LOCAL UNDERSTANDING AND EXPERIENCE



Proven Local Experience and Understanding

WE KNOW CONCRETE SKATEPARK DESIGN-BUILD IN BAY COUNTY... Over the past 3 years, our team has had the privilege of creating meaningful community relationships in Bay County through our Design-Build delivery of the **Downtown Panama City Skatepark**. This has afforded our team with a **proven in-depth understanding of local design + costing considerations and exceptional ability to navigate the community outreach process, CPCB/ Northwest Florida regulatory requirements, and the nuances of the Panama City Beach construction environment.**

Unique and Extraordinary Project Delivery

NOT 'JUST ANOTHER' SKATEPARK... While a base scope of work is outlined for this project, our team intends on delivering a final design and construction program that will far exceed minimum project requirements and provide a considerable amount of additional value to the CPCB. **We not only want to create an amazing skatepark, but an amazing public space that will serve as a marquee component of Frank Brown Park. On top of bold, compelling, and highly accessible forms of street-style terrain inviting to all abilities (beginner and intermediate in particular), we look forward to working with local youth and families to create a 'signature' of community. Specifically this means a final design-build program that incorporates skateable art/sculpture, inviting viewing and socializing areas, innovative energy-efficient lighting, a robust 'green'/LID civil drainage program, and strong connections to the greater Frank Brown Park context. Additionally, in recognition of team's our 23rd anniversary, we look forward to providing the following value-added offerings at no-charge.**

PAGE INTENTIONALLY
LEFT BLANK

(SEE FOLLOWING PAGES FOR RELEVANT EXPERIENCE AND REFERENCES)

- Post occupancy skatepark programming consulting and 3 day residency for school-based skateboarding program
- Grand opening event production assistance including securing high-level professional skateboarders (including our own Kanten Russell) and bikers for through our team's connections to some of the world's elite action sports athletes and their industry sponsors
- Professional video production of grand opening festivities and the related park development journey
- \$2,000 in professional skateboarding/BMX/Scooter/Inline prizes for park opening celebrations

Proven Design-Build Experience

MUNICIPAL SKATEPARK DESIGN-BUILD IS IN OUR DNA... **Over the past 5 years, our team has been involved in approximately 45 municipal concrete skateparks executed via fixed priced Design-Build contracts.** For practicality, we have profiled 8 projects within the following pages that illustrate the depth of our design and construction capabilities in the lead designer and prime contractor role.

Panama City Skate Spot Panama City, FL

Located near the heart of Downtown Panama City, our team collaborated with the local community and municipal staff to realize the final design of this exciting new urban youth park project. Traditional street elements such as ledges and rails, manual pads, banks and step-ups are complimented by creative integral colored concrete, viewing areas, tactful stormwater management zones, and strong connections to pedestrian access points + surrounding parking. The facility is testament to what is possible in a limited footprint in a unique urban context - offering a versatile community recreation element for all ages and ability levels.

Project Budget: \$230,000
 Timeline: Spring 2020 - Fall 2020
 Client: City of Panama City, Kesia Milner
 kmilner@pcgov.org, 850.872.3199

Team Responsibilities:	Financial Summary
- site analysis + public process	GMP \$230,000
- conceptual and final design	Gen Cnds -16%, Ovhd -15%, Profit -8%
- full construction services	Change Orders Added to GMP- \$0
	Design and Pre Construction - \$20,000



*"Dedicated to Excellence...
People Serving People"*

November 09, 2020

To Whom It May Concern,

It is with great pleasure I recommend New Line Skateparks for any design-build skatepark project. New Line Skateparks was contracted in the fall of 2020 by the City of Panama City to construct and build our skatepark. The New Line team was very professional, organized and efficient when working on our project.

New Line Skateparks' dedication and passion for the project was always evident. The team had excellent communication, whether it was with the public, the city leaders or among themselves. They were always willing to work with the City and take on work that would deliver a quality product.

In addition to great communication, their staff was very knowledgeable about the technical aspects of the designs and parks, and went beyond to offer support about the skateboarding community and best practices in keeping the parks working after they leave the site. They were always transparent and realistic in terms of budgets and timelines to the point where the project was completed a head of schedule.

Thank you, and if you have any questions please don't hesitate to contact me at 850.872.3199 ext. 4558

Kesia Milner, Ed.D

Quality of Life Department- Arts & Culture Coordinator

Main: 850.872.3199

kmilner@pcgov.org

Rolling Magic Skatepark Lenexa, KS

This modern skatepark both replaces and pays homage to one of the first generation of concrete skate facilities developed in Kansas. Utilizing a similar footprint and recycling much of the concrete sub base of the original facility, the new park offers a state of the art update and exemplifies the integrated design sensibilities and exacting construction best practices of contemporary skatepark development. Along with a versatile modern transition and street terrain, the final landscaping plan invites individuals of every age to participate, spectate, and enjoy the overall environment. The expansive flow bowl is already sparking a pilgrimage of transition riders from across Kansas while the street section serves riders of every ability.

Project budget: ~\$770,000
Timeline: Fall 2022 - Summer 2023
Client: City of Lenexa, Logan Wagler, 913.477.7140

Team Responsibilities:	Financial Summary
-site analysis	GMP \$850,000
-public process	Gen Ovrds ~17% Ovrhd ~14% Profit ~7%
-conceptual and final design	Change Orders Added to GMP: ~\$0
-full construction responsibilities	Design and Pre Construction ~\$70,000



October 5, 2023

To whom it may concern,

I am writing to recommend NewLine Skateparks for any skatepark or pump-track related project. The Newline team was a pleasure to work with from start to finish and we had an incredibly positive experience.

Lenexa Parks and Recreation contracted with Newline in 2022 to design, facilitate a robust community engagement process, and construct a fully inclusive skatepark to replace our existing park which was over 21 years old. They did a great job of helping us define the program, project goals, and lead us through the process. Being a replacement project and being located within a metropolitan area, public input was a critical component. They did a great job of leading the public open houses, setting up online surveys, and communicating with interested parties. What I appreciated most is that they were able to balance the needs and priorities of the various groups as everyone wanted something different. They were creative in their concepts, went the extra mile to explore options, and most importantly, kept us within budget.

Their staff was responsive, professional, innovative, and extremely passionate. Newline Skateparks delivered on what was promised and the entire process was one of the smoothest projects I have ever been involved with. They met all project timelines, budgets, and performed high-quality work. You can tell that skateparks are more than just a job for their employees, it's a passion and they pour their selves into each project.

Please don't hesitate to reach out with any questions.

Logan Wagler
Director of Parks and Recreation
Lenexa Parks and Recreation

Bonita Springs Skatepark Bonita Springs, FL

With a goal of providing the highest durability, greatest design versatility, and most accommodating riding surface for small wheels (skateboard, inline, scooter) AND larger-wheel activities (mountain bike, BMX), the City of Bonita Springs embarked on the creation of a poured in place concrete pumptrack and modern skatepark combination. The facility was completed in Spring 2021 with considerable fanfare among locals and eager visitors from across the State. In addition to the unique terrain assortment, the facility also features accessible pathway tie-ins, integral concrete color inspired by the City's logo, and a concrete patio/viewing zone lining the length of the park's perimeter.

Project Budget: ~\$1,120,000
 Timeline: Fall 2020 - Summer 2021
 Client: City of Bonita Springs - Nicole Perino
 nicloe.perino@cityofbonitasprings.org 239.992.2556

Team Responsibilities:

- site analysis + public process
- conceptual and final design
- full construction services

Financial Summary

Owner Budget = GMP
 Gen Cnds ~16%, Ovhd ~17%, Profit ~5%
 Change Orders Added to GMP- \$60,000
 Pre Construction ~\$25,000



March 11, 2024

To Whom it May Concern,

In September of 2023, we contracted with New Line Skateparks, to construct our new 16,500 square foot skate park facility. The construction began just before our coast was hit by Hurricane Ian. Although our city was in chaos, roads were shut down, materials and housing were scarce, the New Line team pushed on and delivered a world class skate facility. Project Manager, Tony Misiano leads a talented group of builders, who are passionate about the quality of their work. Plus, they are a blast to watch ride their skateboards after the work is complete! Additionally, they were very quick to respond to a warranty/maintenance visit request, which we value greatly in Parks and Recreation.

We whole-heartedly recommend New Line Skateparks for any and all upcoming skatepark-related projects. Feel free to reach out to me if you have any questions.

Nicole Perino
 Parks and Recreation Director



phone | (239) 992-2556
 email | Nicole.perino@cityofbonitasprings.org
 website | www.cityofbonitasprings.org

C. Jay Smith Skate Plaza & Pump Track Newnan, GA

Newnan's highly anticipated new regional skatepark is now complete. Located in the city's beloved C. Jay Smith Park, the park features ~ 34,000 sqft of unique urban plaza terrain, a competition level bowl unit, and world-class concrete pump track area punctuated by multiple green islands. Along with a one-of-a-kind hard-scape configuration detailed with the City's colors, the greater park offers new visitor parking, restrooms, an adventure playground, splash park, custom site furnishings, and linkages to public transit and pathways. The park is among the region's largest and most progressive youth facilities - attracting visitors from across the Country and serving as an appealing venue for high-level action sports contests, demonstrations, and events.

Project Budget: \$1,900,000
Timeline: Fall 2020 - Summer 2021
Client: City of Newnan - Cleatus Phillips, City Manager
 cphillips@cityofnewnan.org 770-254-2358

Team Responsibilities:

- site analysis + public process
- conceptual and final design
- full construction services

Financial Summary
 Owner Budget = GMP
 Gen Cnds -15% Ovhd -15% Profit -8%
 Change Orders Added to GMP: \$0
 Design and Pre Construction - \$140,000



C.J. Smith Skatepark continued



Greeley Skatepark Network Greeley, CO

In 2018 the City of Greeley retained New Line Skateparks to create not just one, but a network of three modern concrete skateparks strategically distributed throughout the city. This master-planned development allows the majority of Greeley residents to have access to a skatepark within just over a mile of their residence - each with a distinct character, unique terrain style and site integration approach.

Informed by an exciting community engagement process consisting of a series of interactive design workshops and open house sessions, the final design program resulted in a Flow/Transition oriented Facility at Centennial Park, an expansive modern Street-Style Plaza at 3rd Street, and a versatile Skate Spot (existing concrete slab retrofit) at Peakview Park. Our team also collaborated closely with the City's Public Art program to incorporate custom installations by sculptor Joshua Goss into each facility footprint.

Team Responsibilities:

- site analysis
- public consultation
- conceptual and final design
- full construction services

Project Budget: ~ \$1,800,000

Timeline: Winter 2018 - Spring 2020

Andy McRoberts, CPRE

Director - Culture, Parks and Recreation
970-350-9425

Financial Summary

Owner Budget = GMP
Gen Cnds ~18%, Ovtid ~16%, Profit ~7.5%
Change Orders Added to GMP - \$0
Design and Pre Construction ~ \$120,000



Greeley Skatepark Network continued

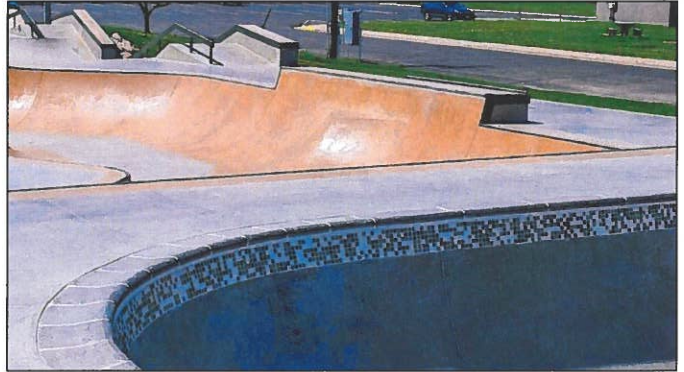

CityWalk Skatepark Birmingham, AL

Now completed, CityWalk BHAM includes a 31-acre, 10-block-long linear public park underneath the I-59/I-20 bridges in downtown Birmingham, featuring world-class design and pedestrian amenities that provide active and passive recreational gathering opportunities. Working closely with Barge Design Solutions, ALDOT, the City and local stakeholders, the skatepark solution was developed to not only fit the thematic structure of the CityWalk landscape but to also offer a completely unique experience within the context of this one of a kind under-viaduct urban environment. Complementing surrounding children's playscapes, an outdoor skating rink, a dog park, walking paths, multiple performance spaces and gathering areas, the skatepark features a balanced mix of transition, flow, street and pump track obstacles while adhering to the traffic, inspection and pedestrian pathway requirements of ALDOT and the City of Birmingham. With a footprint of over 56,000 sqft, the skatepark will also serve as one of North America's largest action sports destinations.

Timeline: Spring Spring 2020 - Summer 2022

Budget: ~\$3.5 Million

Client: City of Birmingham / ALDOT - Steve Haynes
hayness@dol.state.al.us (East Central Region Engineer)

Team Responsibilities:

- site analysis
- public process
- conceptual and final design
- concrete skatepark construction

Financial Summary

- Gen Cnds ~15%, Ovthd ~15%, Profit ~9%
- Change Orders Added to GMP- \$0
- Design and Pre Construction ~\$130,000

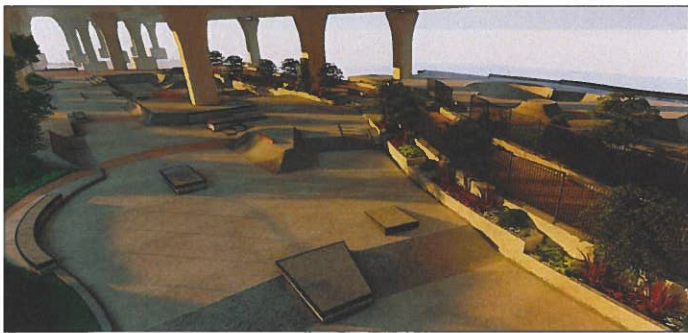

CityWalk Skatepark...continued

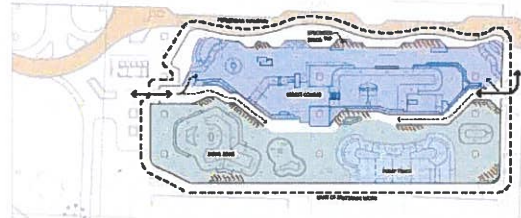

CityWalk Skatepark...continued

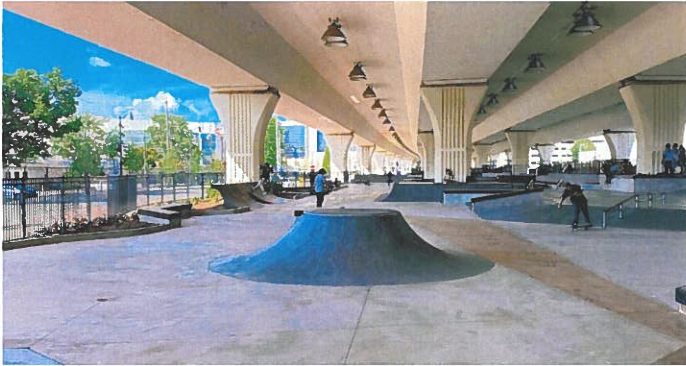

CityWalk Skatepark...continued

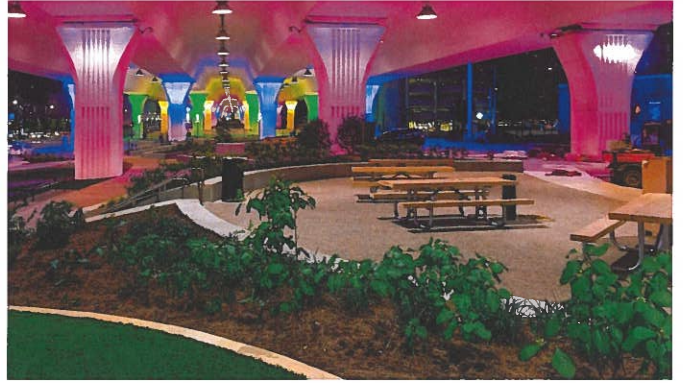
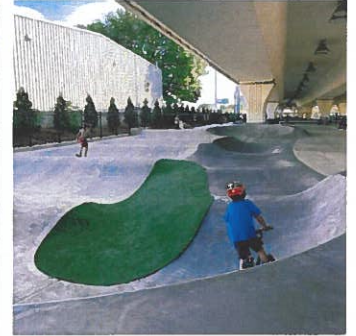
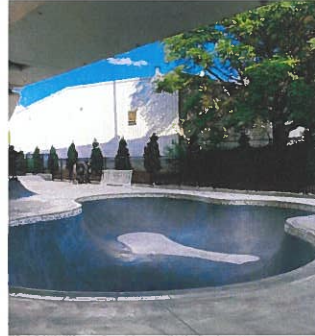

Mueller Skatepark and Pump Track *Austin, TX*

Located in the heart of the 700-acre award winning, master-planned Mueller community (a redevelopment of Austin's Robert Mueller Municipal Airport), is Texas's first combination concrete pump track and urban skate plaza development. Along with offering a versatile assortment of custom skateboarding, BMX/Mountain Bike, inline, and scooter-friendly terrain, the park also serves as a marquee family gathering and socializing area within the community's expansive Southeast Greenway recreation and natural lands corridor. Beloved by locals and visitors alike, the facility has garnered considerable Nation-wide acclaim, demonstrating what's possible when Residential Developers, City Staff, Action Sports Consultants, and Community Members can accomplish when working together.

Project Budget: ~ \$1,100,000
Timeline: Fall 2021 - Summer 2022
Client: Catelus Developments

Team Responsibilities
- site analysis
- public process
- conceptual and final design
- full construction services

Financial Summary
Owner Budget = CMP
Gen Cnds ~13%, Ovhd ~15%, Profit ~7%
Change Orders Added to GMP- \$0
Design and Pre Construction ~\$85,000

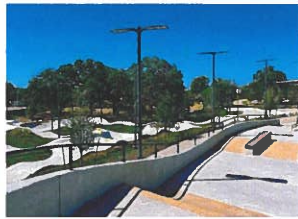

Topaz Skate Plaza + Bike Skills Park Victoria, BC

The City of Victoria's Topaz Skate Plaza and Bike Skills Park serves as one of Canada's largest integrated action sports venues and is quickly gaining world wide attention as a top skateboarding and BMX/Mountain bike destination. On top of premium plaza, obstacle, pump track, and modern bowl terrain, the development features integrated rain gardens, custom lighting and sculptural elements, innovative wayfinding and shade structure elements, and extensive viewing areas, event space and formalized pedestrian corridors. Our team was proud to serve as Prime Contractor and Lead Designer to bring this landmark community project to life for the vibrant community of Victoria.

Project Budget: \$3,600,000
Timeline: Spring 2021 - Spring 2022
Client: City of Victoria, Moira Wilson, mowilson@victoria.ca

Team Responsibilities	Financial Summary
- site analysis	Owner Budget = GMP
- public process	Gen Cnds ~18%, Ovhd ~16%, Profit ~6%
- conceptual and final design	Change Orders Added to GMP: \$0
- full construction services	Design and Pre Construction ~\$260,000
- programming consulting	

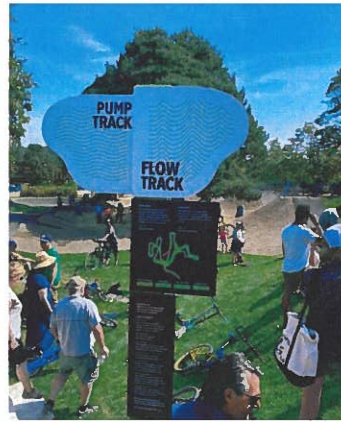



*ORGANIZATIONAL PROFILE
AND PERSONNEL*
QUALIFICATIONS



TEAM ORGANIZATION AND KEY PROJECT STAFF

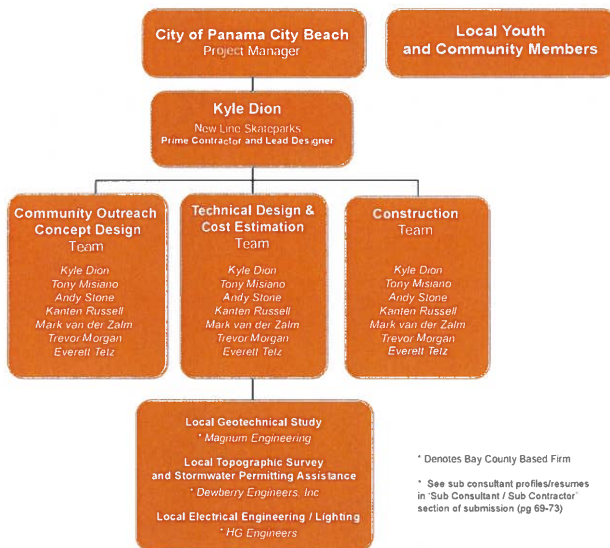

As Prime Contractor and Lead Designer, New Line Skateparks will direct all project action and self-perform all specialized skatepark community consultation, certified design and complex concrete and steel construction works. All remaining non skatepark-specialized construction scopes such as bulk earthworks, finishing landscaping, etc will be executed under our direction by reputable local Bay County contractors. Similarly, all major materials (sub base aggregate, concrete, rebar, lumber, etc.) will also be sourced locally through an internal RFP process. These materials and non skatepark-specific scopes will also serve as strong opportunities for In-Kind Donations (should the Owner be interested in pursuing).

The effectiveness of our core team and design-build organizational structure has been proven and enhanced over 450 projects throughout Florida and across North America. Orderly internal communication, coordination of activities, and our distribution of key project information will be informed by our 23+ years of municipal design-build project management experience and general compliance with ISO 9001 quality assurance measures. Subcontractors/Subconsultants will have clearly defined scopes of work + contracts and will be vetted for final approval with the CPCB prior to engagement.

28

At New Line Skateparks we understand the part that 'local' plays in developing livable and lively communities. At the same time we understand the value of using cutting edge designers with international experience and recognition. Thus, we have assembled a carefully selected multi-disciplinary team of passionate professionals with both world-class credentials and unparalleled local resources. *Please see previous section for Key Staff project reference information (Principal and Project Management Staff have worked together on all projects profiled in our Firm Qualifications).*

KYLE DION

President and Project Director



Mr. Dion is the founder and president of New Line Skateparks Inc. and will direct all action for the project at hand. He is a seasoned active skateboarder and father of 5 who has tirelessly dedicated himself to the promotion of skateboarding/action sports across North America and throughout the world. Kyle is also a current executive board member of CASA (which coordinated CDN skateboarding's debut in the 2021 Olympic Games in conjunction with the International Olympic Committee) and has provided his professional consulting and construction services for over 450 high profile municipal skateparks across the United States, Canada, Europe, and Australia. In addition to receiving numerous recognitions for his work (including the esteemed Canadian Society of Landscape Architects National Honour Award), Mr. Dion is regularly featured in international media publications for his unique community recreation contributions.

PROFESSIONAL EXPERIENCE

New Line Skateparks
Edgewater, FL
President / Principal Designer
2001 - Present

Puzzled Skate Movement
Maple Ridge, BC
President
1997 - 2001

City of Maple Ridge
Maple Ridge, BC
Youth Program Specialist
1994 - 1997

Luxton Designs
Perth, Australia
Project Manager
1990 - 1994

PROFESSIONAL AFFILIATIONS

American Shotcrete Association

Skateboard Canada
(Board Member)

PROFESSIONAL AWARDS

CSLA - Regional Honor Award - Vancouver Skate Plaza
CSLA - National Honor Award - Plaza at the Forks
Skaters for Public Skateparks - Public Space Award - Plaza at the Forks
Parks and Recreation Ontario - Excellence in Design Award
Texas Recreation and Parks Society - Excellence in Design Award
CSLA National Citation - Calgary Skateboarding Amenities Strategy
American Shotcrete Association - Outstanding Shotcrete Award

PROJECT EXPERIENCE

(project values \$300,000 - \$3 Million)

Downtown Panama City Skatepark - Panama City, FL
Bonita Springs Skatepark - Bonita Springs, FL
Helen McCall Skatepark - Walton County, FL
Topaz Skatepark and Bike Park - Victoria, BC
C Jay Smith Skate Plaza and Pump Track - Newnan, GA
Rolling Magic Skatepark - Lenexa, KS
CityWalk Skatepark - Birmingham, AL
Creston Skatepark - Creston, BC (2019)
Plaza at the Forks - Winnipeg, MB
Calgary Skateboarding Amenities Strategy - Calgary, AB
Banff National Park Skatepark - Banff, AB
Kensington Skatepark - Vancouver, BC
Seattle Center Skatepark - Seattle, WA
South Kitsap Skatepark - Port Orchard, WA
Lafayette Skate Plaza - Los Angeles, CA
SOMA Skate Plaza - San Francisco, CA
House Park Skate/BMX Park - Austin, TX

Additional Project Experience Listing Available Upon Request

167



TONY MISIANO
Construction Superintendent



MARK VAN DER ZALM LEED AP, ASLA, CSLA
Principal Landscape Architect



Living in Edgewater FL, Tony Misiano is high-level skateboarder and construction superintendent with over 20 years of successful concrete skatepark development experience across the United States. Tony personally oversees all cost estimation and construction operations from first shovel through to grand opening to ensure full continuity and quality control through each phase of development. Tony is an ACI Certified Shotcrete Nozzlemen, a licensed General Contractor, COR Safety and ISO 90001 compliance trained, and will serve as lead estimator and construction manager for the project at hand.



Mr. van der Zalm is the serves as the principal landscape architect for our team. His duties will include liaising with the client, stakeholders and the public as well as certified design development and project management. Mr. van der Zalm is a registered member of both the American and Canadian Society of Landscape Architects and has been the recipient of Regional and National Honor awards for his work across North America and Europe. He holds a masters degree in landscape architecture and environmental planning with design expertise centered on parks and recreation development and urban design. Mark has served as landscape architect on over 300 of the continent's most recognized concrete youth/skateparks and is a frequent presenter on youth park development across the globe.

PROFESSIONAL EXPERIENCE

- Newline Skateparks**
Edgewater, FL
Superintendent, US Construction
General Contractor CGC1513874
July 2017 – Present
- Misiano Skateparks**
New Smyrna Beach/Edgewater, FL
President and Founder
General Contractor CGC1513874
Designer and Builder Over 50
Skateparks in 10 States
July 2007 – July 2017
- New Smyrna Beach Skatepark Committee**
New Smyrna Beach, FL
Member of Non-profit Organization
Winner Volusia County Echo Grant
Winner Tony Hawk Foundation Grant
December 2005 – August 2008
- Traveling Professional Skateboarder**
New York, NY – home base
Tokyo, Seoul, 28 of 50 US States
January 99 – December 2005
- Concrete Foreman**
110 Liberty Street, LLC
New York, NY – Ground Zero
Concrete Construction and Carpentry
January 2002-July 2003

EDUCATION

- University of Central Florida
BA Arts Administration 1994
- Second Studio, NY, NY
Method Acting Conservatory 2000-2003
- Certified General Contractor
CGC1513874 Florida, July 2007

PROJECT EXPERIENCE

- (project values \$300,000 - \$2.5 Million)
- Downtown Panama City Skatepark - Panama City, FL
 - Bonita Springs Skatepark - Bonita Springs, FL
 - Helen McCall Skatepark - Walton County, FL
 - C Jay Smith Skate Plaza and Pump Track - Newnan, GA
 - Rolling Magic Skatepark - Lenexa, KS
 - CityWalk Skatepark - Birmingham, AL
 - LaGrange Skatepark, LaGrange, GA
 - Sandwich Skatepark, Sandwich, MA
 - Whistlestop Skatepark, Whistlestop, FL
 - Colin's Dream Park, Orange City, FL
 - Stratford Skatepark, Stratford, Ontario
 - Banff Skatepark, Banff, Alberta
 - Albany's Washington Park Skatepark, Albany, NY
 - Raymondville Skatepark, Raymondville, TX
 - Los Fresnos Skatepark, Los Fresnos, TX
 - Youth Activities Skatepark, O'Fallon, MO
 - Nyack Memorial Skatepark, Nyack, NY
 - Charles R. Woods Skatepark, Lake George, NY
 - Ronald Reagan Skatepark, Lawrenceville, GA
 - Nova Community Skatepark, Ormond Beach, FL
 - Bayhead Action Skatepark, Largo, FL
 - Procko Park Skatepark, Branford, FL
 - New Richmond Skatepark, New Richmond, WI
 - Buena Vista Skatepark, Buena Vista, CO
 - Scituate Skatepark, Scituate, MA
 - Ian Tilmann Memorial Skatepark, Safety Harbor, FL
 - Forestgate, Lakeside, Harpers Landing & Terramont Skateparks.

Additional Project Experience Listing Available Upon Request

EDUCATION

- Masters of Landscape Architecture
and Environmental Planning Degree
Utah State University

PROFESSIONAL AFFILIATIONS

- RLA Texas
- RLA Florida
- RLA Colorado
- RLA Kansas
- RLA Oregon
- RLA Michigan
- RLA Georgia
- LEED AP
- ASLA

PROFESSIONAL EXPERIENCE

- New Line Skateparks**
Langley, BC / Edgewater, FL
Principal Landscape Architect
2001 - Present
- VDZ + associates inc.**
Vancouver, BC
Principal
2000 - Present
- DMG Landscape Architects**
Burnaby, BC
Associate
1996 - 1998
- Diseno Pasajista**
Porto Vejo, Ecuador
Sr. Design Associate - Summer
Exchange Program

PROFESSIONAL AWARDS

- CSLA - Regional Honor Award - Vancouver Skate Plaza
- CSLA - National Honor Award - Plaza at the Forks
- Skaters for Public Skateparks - Public Space Award - Plaza at the Forks
- Parks and Recreation Ontario - Excellence in Design Award
- Texas Recreation and Parks Society - Excellence in Design Award
- CSLA National Citation - Calgary Skateboarding Amenities Strategy
- American Shotcrete Association - Outstanding Shotcrete Award

PROJECT EXPERIENCE

- (project values \$300,000 - \$2.5 Million)
- Downtown Panama City Skatepark - Panama City, FL
 - Bonita Springs Skatepark - Bonita Springs, FL
 - Topaz Skatepark and Bike Park - Victoria, BC
 - C Jay Smith Skate Plaza and Pump Track - Newnan, GA
 - Rolling Magic Skatepark - Lenexa, KS
 - CityWalk Skatepark - Birmingham, AL
 - Helen McCall Skatepark - Walton County, FL
 - Plaza at the Forks - Winnipeg, MB
 - Calgary Skateboarding Amenities Strategy - Calgary, AB
 - Banff National Park Skatepark - Banff, AB
 - Lake Wilcox Youth Park - Richmond Hill, ON
 - Gellert Community Skatepark - Halton Hills, ON
 - Vancouver Skate Plaza - Vancouver, BC
 - Chuck Bailey Youth Park - Surrey, BC
 - Seattle Center Skatepark - Seattle, WA
 - Kensington Skatepark - Vancouver, BC
 - Melfort Skatepark - Melfort, SK
 - Chinook Winds Skatepark - Airdrie, AB
 - Station One Skate Plaza - Saint John, NB
 - Fredericton Downtown All Wheel Plaza - Fredericton, NB
 - Seattle Center Skatepark - Seattle, WA

Additional Project Experience Listing Available Upon Request



ANDY STONE P.E.N.G.
Project Engineer



KANTEN RUSSELL
Sr Skatepark Designer and Design Project Manager



EDUCATION

BS Civil, Environmental and Infrastructure and Engineering
George Mason University
Fairfax, Virginia

CERTIFICATIONS

Certified Pipeline, Manhole, and Lateral Assessment Certification
National Association of Sewer Service Companies (NASSCO).2016
Inspector Training Certification Program for Manhole Rehabilitation, NASSCO. 2013
30-Hour Construction Safety OSHA, 2013
First Aid / CPR, American Heart Association, 2018

Andy brings nearly 20 years of experience as a senior civil engineer (Florida License 96794) and project manager specializing in land development, infrastructure rehabilitation, water distribution and LID storm water management systems for public sector projects - including over 40 municipal skatepark developments across North America. With a strong project management background, Andy enjoys staying directly involved with the client and project stakeholders as well as technical design leads from all other professional disciplines contributing to the design. Andy was also a professional skateboarder from 1993 to 1999, during which he traveled the world competing and performing demonstrations as well as helping manage a team, assist in art direction, and overseeing production of advertising and board graphics. Andy will serve as lead engineer for the project at hand.

SKATEPARK PROJECT EXPERIENCE

(project values \$300,000 - \$2.5 Million)

Rolling Magic Skatepark - Lenexa, KS
Bonita Springs Skatepark - Bonita Springs, FL
Barrhead Skatepark + Pump Track - Barrhead, AB
Fernie Skatepark Redevelopment (2023) - Fernie, BC
Spruce Grove Skatepark Redevelopment (2023) - Spruce Grove, AB
Arvada Skate Park, Arvada, Colorado
Ethies Skate Park, Lake Forest, California
Erie Community Skatepark, Erie, Colorado
Malooof Skate Park, Washington, DC
Oldsmar BMX Track, Oldsmar, Florida
Oakland Skate Park, Oakland, California

INFRASTRUCTURE PROJECT EXPERIENCE

Sanitary Sewer Collection Beach Interceptor Trenchless Technology Improvements, Laguna Beach, CA
National Zoological Park – Asia Trail Project, Smithsonian Institution, Washington, DC
DC Water System Improvement Project - Aurora Water, Aurora, CO
Manhole Rehabilitation Project, South Adams County, CO
Sanitary Sewer Collection System Rehabilitation, Aurora, CO
Infrastructure Rehabilitation – Miller Coors Brewery, Golden, CO
Adams County Government Center, Brighton, CO

Additional Project Experience Listing Available Upon Request



EDUCATION

AS, Engineering Survey & CAD Design, Cuyamaca College, San Diego, California

AWARDS

2018 ASLA New York Upstate Chapter Merit Award, Planning and Analysis (Rochester Urban Skate Park)
2017 American Public Works Association (APWA) Southern California Chapter, Creative & Innovative under 50,000 sq ft (Manhattan Beach Skate Park)
2016 California Parks & Recreation Society Award (CPRS) District 12, Best New Facility (Encinitas Community Plaza and Skate Plaza)
2014 California Park & Recreation Society Award of Excellence, Alga Norte Community Park (Skate Park)
2014 American Public Works Association - San Diego & Imperial Counties Chapter Public Works Project of the Year (Alga Norte Community Park (Skate Park))

Kanten is a globally recognized professional skateboarder with over 14 years of international experience endorsing his pro model shoes and signature skateboards. Kanten worked for the City of Chula Vista in the engineering/surveying department followed by a decade in the architectural design world serving as a skatepark development consultant. Since turning to design, Kanten has spent the last 13 years utilizing his knowledge of action sports on over 260 municipal youth park facilities, including skateparks, urban plazas, and progressive pump tracks. Kanten's specialized technical expertise is uniquely informed by his experience on the professional skateboard circuit as well as being a father of 3 girls - resulting in creative material and surface choices as well as compelling variations in flow and complexity of obstacles. Kanten has been with New Line Skateparks since 2018 and will serve as lead terrain designer for the project at hand.

PROJECT EXPERIENCE

(project values \$300,000 - \$3 Million)

Downtown Panama City Skatepark - Panama City, FL
Bonita Springs Skatepark - Bonita Springs, FL
Helen McCall Skatepark - Walton County, FL
Topaz Skatepark and Bike Park - Victoria, BC
C-Jay Smith Skate Plaza and Pump Track - Newman, GA
Rolling Magic Skatepark - Lenexa, KS
CityWalk Skatepark - Birmingham, AL
Ypsilanti Skatepark, Ypsilanti, Michigan, (2019)
Rochester Urban Skate Park, Rochester, NY (2019)
Reservation Road Skate Park, Boston, MA (2019)
Washington Park Skate Park, Albany, NY (2013)
Nyack Skate Park, Nyack, NY (2015)
Faber Skate Park, Staten Island, NY (2015)
Lynch Family Skate Park, Cambridge, MA (2015)
Holyoke Skate Park, Holyoke, MA (2013)
Skate Corridor & Pump Track at Smith Playground, Boston, MA (2018)
Sandwich Skate Park, Sandwich, MA (2019)
Encinitas Community Park Skate Plaza, Encinitas, CA (2015)
City Heights Skate Park, San Diego, CA (2018)
Eagan Skate Park, Eagan, MN (2018)
Watermark Skate Park, Lethbridge, AB (2018)
Dunnville Skate Park, Haldimand County, ON (2015)
Caledonia Skate Park, Haldimand County, ON (2015)
The Station at Gulfport Park, Houston, TX (2017)
Appleton Skate Park at Telulah Park, Appleton, WI (2013/2017)
Goodman Skate Park, Madison, WI (2015)
Lake Geneva Wheel Plaza, Lake Geneva, WI (2012)
Heritage Skate Plaza, St. Cloud, MN (2011)
T.J. O'Grady Memorial Skate Park Bowl Phase, Acton, MA (2018)

Additional Project Experience Listing Available Upon Request



TREVOR MORGAN BComm
Vice President / Facility Development Strategy



Mr. Morgan is an active skateboarder with over 22 years of large-scale municipal project development experience. His dedicated work has contributed to the creation of over 250 highly recognized ongoing youth organizations, public skateparks, and emerging sport programs across Canada, the United States, Europe and South America. Mr. Morgan is also an internationally respected speaker on the subject of municipal youth park / wheeled sports facility planning - presenting on a regular basis to State planning and recreation organizations across North America. Trevor will serve as co-principal for the project at hand - focusing on overall facility development strategy, design-build process continuity and public consultation.

PROFESSIONAL EXPERIENCE

New Line Skateparks
Langley BC
Vice President
2005 - Present

Newell Industries
Mississauga, ON
Key Account Manager
2003 - 2004

City of Calgary
Calgary, AB
Skatepark Specialist
1998 - 2003

EDUCATION

Bachelor of Commerce
University of Calgary
Calgary, AB, 2003

PROFESSIONAL AFFILIATIONS

American Shotcrete Association

Alberta Recreation and Parks Association (Corp Member)

PROFESSIONAL AWARDS

Eaton Foundation Academic Scholarship - 2002
Avenue Magazine Top 40 Under 40 - 2011
CSLA - National Honor Award - Plaza at the Forks
Skaters for Public Skateparks - Public Space Award - Plaza at the Forks
Parks and Recreation Ontario - Excellence in Design Award
Texas Recreation and Parks Society - Excellence in Design Award
CSLA National Citation - Calgary Skateboarding Amenities Strategy
American Shotcrete Association - Outstanding Shotcrete Project Award

PROJECT EXPERIENCE

(project values \$300,000 - \$3 Million)

Downtown Panama City Skaepark - Panama City, FL
Bonita Springs Skatepark - Bonita Springs, FL
Topaz Skatepark and Bike Park - Victoria, BC
C Jay Smith Skate Plaza and Pump Track - Newnan, GA
Rolling Magic Skatepark - Lenexa, KS
CityWalk Skatepark - Birmingham, AL
Vic West Skatepark Expansion - Victoria, BC
Barrhead Skatepark + Pump Track - Barrhead, AB
Calgary Skateboarding Amenities Strategy - Calgary, AB
Banff National Park Skatepark - Banff, AB
Fernie Skatepark Redevelopment (2023) - Fernie, BC
Creston Skatepark - Creston, BC (2019)
Plaza at the Forks - Winnipeg, MB
Vancouver Skate Plaza - Vancouver, BC
Chuck Bailey Youth Park - Surrey, BC
Queensborough All-Wheel Park - New Westminster, BC
Kensington Skatepark - Vancouver, BC
Seattle Center Skatepark - Seattle, WA
South Kitsap Skatepark - Port Orchard, WA
Lafayette Skate Plaza - Los Angeles, CA
SOMA Skate Plaza - San Francisco, CA
House Park Skate/BMX Park - Austin, TX
Umea Skatepark - Umea Sweden

Additional Project Experience Listing Available Upon Request



EVERETT TETZ
Community Outreach and Programming



Everett Tetz is a former Vice Principal of the Red Deer Public School district. He has a breadth of experience working with youth and was an active member of the provincial Diversity, Equity and Human Rights committee for several years. Everett has a passion for re-thinking the way we connect with youth and believes that their involvement in education and community needs to be meaningful and authentic. In 2013, Everett created Skate Class - a school based skateboarding program that is the first of its kind in North America with it's own locally approved curriculum. Everett has since launched a non-profit organization that seeks to connect marginalized populations to their communities by providing mentorship, training, and support, through skateboard programming and outreach. Everett is eager to connect with communities across Florida interested in involving youth, community agencies and other stakeholders in the planning, designing and construction of custom skatepark facilities and exploring a variety of programming opportunities. **As a valued-added service for the project at hand, Everett will be available to meet with local programmers and share the Skate Class curriculum, and assist the CPCB with exploring the creation of other sustainable/ongoing, community-driven skatepark programming initiatives.**

EDUCATION

University of Calgary 2014-2017
Interdisciplinary Master's in Education

University of Alberta 2009
Bachelor of Education
(with distinction)

PROFESSIONAL EXPERIENCE

New Line Skateparks
Langley BC
Manager of Community Outreach
2017 - Present

Academy Skateboard Collective
North America
Founder and Director
2013 - Present

Skatelistan Canada
Treasurer for Canadian
Fundraising Entity
2019-Present

Red Deer Public Schools
Red Deer, Alberta
Vice Principal / Teacher
2014 - 2017

Red Deer Public Schools
Red Deer, Alberta
School Counsellor / Teacher
2011-2014

PROJECT EXPERIENCE

(project values \$300,000 - \$3 Million)

Downtown Panama City Skaepark - Panama City, FL
Bonita Springs Skatepark - Bonita Springs, FL
Topaz Skatepark and Bike Park - Victoria, BC
C Jay Smith Skate Plaza and Pump Track - Newnan, GA
Rolling Magic Skatepark - Lenexa, KS
CityWalk Skatepark - Birmingham, AL
Qualicum Beach Skatepark Redevelopment (Current)
Topaz Skatepark and Bike Park - Victoria, BC (2021)
Westshore Skatepark (2022)
Tofino Skatepark Refurbishment (2020)
Vic West Skatepark Expansion - Victoria, BC
Fernie Skatepark Redevelopment (2023) - Fernie, BC
Spruce Grove Skatepark Redevelopment (2023) - Spruce Grove, AB
CitySkate (Vancouver Skateboard Amenities Strategy), (2022)
Fire Station Skate Plaza, Fort Worth, TX (2023)
Ypsilanti Skatepark, Ypsilanti, Michigan
CityWalk Skatepark, Birmingham AL
Calgary Skateboarding Amenities Strategy - Calgary, AB
Banff National Park Skatepark - Banff, AB
Lake Wilcox Youth Park - Richmond Hill, ON
Gellert Community Skatepark - Halton Hills, ON

Additional Project Experience Listing Available Upon Request

OUR
APPROACH





PROJECT UNDERSTANDING

The residents of Panama City Beach have determined that the development of a modern, highly integrated, and inclusive skatepark would be a welcome addition to the City's parks network. City Council and Staff have supported this initiative with the designation of a site and a commitment of project funding. It is also understood that a passionate group of local skateboarders/wheeled sports enthusiasts, community leaders and parents are standing by to provide creative input throughout the development process.

The proposed site for the project will lie just south of the Miracle League Fields within the community's popular Frank Brown Park. Frank Brown Park has been the focus of significant redevelopment planning that will aim to further establish the site as a destination recreational hub for locals and visitors alike. Thus, introducing the new skatepark will require utmost sensitivity to the area's multiuse surroundings and the guiding principles of the master planning completed to date by the CPCB and consultants, Goodwyn Mills Caywood. Key components in this vein will be ensuring the new skatepark integrates tactfully with the existing natural landscape and addresses the safety, accessibility, aesthetic, visibility, drainage, CPTED, lighting, environmental sustainability and operations/maintenance concerns (ie. programming, hours, garbage, graffiti policy etc.) of City Council, Staff and park visitors.

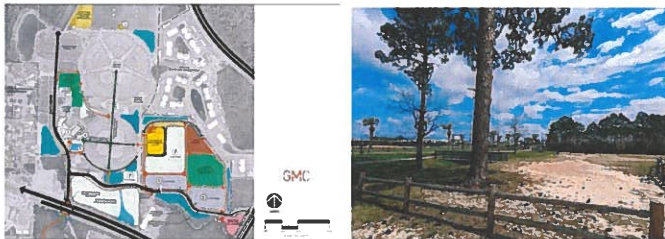

Views of Frank Brown Park master planning process + photos of the project site taken during our team's latest site visit, February 27th, 2024

With key staff based in Edgewater and recent past work in the area (Panama City Skatepark, Walton County Skatepark), our team has maintained strong relationships with the local skateboarding/action sports community. This interaction has continued by way of our attendance at various skatepark related events in the area and a number of visits to Panama City Beach and the proposed project site. **Based on this experience, we know that there is a highly diverse, passionate, and committed community of skateboarders, all wheel enthusiasts, and freestyle bikers - each with a strong culture, history and a fervent desire to seize this incredible development opportunity to create something truly unique in the region. We recognize that the final park user experience must be centered on an equitable approach to design - allowing opportunities for all styles and skill levels of users.**

We anticipate that the park terrain will consist of highly accessible and compelling forms of authentic modern street/plaza and flow features - suitable for all ability levels but highly accommodating to beginner and intermediate users (details of which shall be confirmed through close consultation with the project team and community). Design considerations shall also address the opportunity for users to grow and progress in their skills as well as take into account the park's ability to serve multiple uses and host a variety of programming initiatives. Modern skateparks are amazing family facilities and great to watch, therefore attention must also be given to safe and inviting viewing areas, tactful landscaping, lighting and the inclusion of signature art/sculptural installations (rideable and otherwise) that capture the 'story' of what makes Panama City Beach unique and special.



Above - Local media reporting on the planned improvements to Frank Brown Park. With strong community interest in the skatepark, it will be critical to conduct a meaningful stakeholder input program to relapse the facility's final design.

The Design-Build Team shall ensure the completion of a thorough site analysis, in-depth stakeholder consultation program, creation of the overall conceptual plan, development of all working and as built drawings, permitting, full construction services, and project close-out responsibilities under a fixed price design-build contract. Should there be interest from the Owner, the development process shall also support any community in-kind donation opportunities and other pertinent project information that may be leveraged for added financial support. Having the design-build team become a 'Partner' with the City, and ensuring a meaningful level of local community member/business participation in the appropriate non-specialty scopes of construction will be a key factor in this endeavor.

In conclusion, it is understood that the entire development process shall be undertaken in close collaboration with City Staff, key stakeholders and other interested local youth and community members. This includes seeking the participation of voices that are actively using all-wheel skateparks in increasing numbers but are often underrepresented in the facility public process. **These stakeholders must be respected, fully engaged in the development process, and intimately understood by the skatepark development team.**



OUR APPROACH

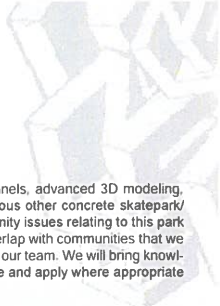

1. Community Consultation: Our experience has shown that active participation by youth and other members of the community throughout the development process will be crucial to the long-term success of the project. For the new Panama City Beach Skatepark the call for stakeholder involvement will be equally important as there has been considerable community interest in the initiative and a significant commitment of municipal land and funding.

Thus, our team will approach this project from a collaborative point of view. We will engage the community throughout the design journey and bring a professional, organized and fun attitude. We want youth and affected community members to truly feel that they are a part of the project solution and build lasting ownership in the final product.

The design team will meet with City Staff, youth and interested community members through a series of key stakeholder meetings and public design workshops. These sessions will allow us to introduce our team, establish open lines of communication and determine the ultimate design vision for the project. If a stakeholder cannot attend one of our 'live' sessions, then we will encourage them to contact us through email or visit the project online surveys that will be created for this project. We will spare no resource to ensure that the experience of designing and building the skate, pump and sport park is as rewarding as using the final product!



To effectively address park development issues discussed with the public in an efficient manner, it will be critical to have experienced and effective facilitators working with the diverse stakeholder groups. Meetings must be led by individuals who not only intimately understand the subtleties and nuances of skateboarding/BMX and youth concerns but who also can relate issues back to area residents, seniors, business owners, civic officials etc.

Our team offers 3 individuals (Kyle Dion, Kanten Russell and Trevor Morgan) - each with 23+ years of individual experience working specifically in urban development and skatepark related planning). We will make certain all stakeholders first understand this unique project and then have an opportunity to be heard while keeping sessions productive and the project timeline 'on track'.

Part of our strategy will include using effective visual aids (color presentation panels, advanced 3D modeling, power point etc.) which illustrate examples and draw on information from numerous other concrete skatepark/plaza developments our team has completed across the nation. Although community issues relating to this park will be truly unique to Panama City Beach, there will be some consistency and overlap with communities that we have previously worked with (over 450 to date). We see this as a major strength of our team. We will bring knowledge gained from similar skatepark projects throughout North America and Europe and apply where appropriate when working with project stakeholders.



Another key aspect of our approach will be keeping our working sessions highly interactive. In addition to 'airing out' important development issues through meaningful discussion, we encourage other types of 'hands on' involvement such as writing, sketching, and real time 3D modeling of park ideas/elements alongside our team within the meetings. Outside of scheduled meetings, stakeholders will be once again invited to submit written comments, sketches, pictures etc. through our custom web survey for feedback and consideration from our team. For even further interaction, youth will be encouraged to assist our team in presenting concept plans and revised design renderings back to the community as the project progresses. In addition, youth/young adults interested in pursuing education related work experience / credit programs will also be invited to participate in our design process where possible (this has proven to be very rewarding on past skatepark projects we have completed).



Check us out! Log on to www.newlineskateparks.com

Overall, engaging key stakeholders in a meaningful way early in the process will be a major key to the project's success. We will seek to gather endorsements in a logical order and work to identify and focus on common goals to bridge gaps between stakeholder groups. Moreover, by researching local issues ahead of time and utilizing empirical information gained from other skatepark projects we have completed, we will strive to preempt many of the contentious issues that can arise from public misconceptions that often surround skatepark developments.

Based on our experience with similar projects, we propose conducting 3 public design workshops and an ongoing series of internal meetings throughout the development program. This should provide ample opportunity to conduct an in depth design development program and allow stakeholders to view and understand the proposed skatepark design objectives. At each major meeting a combination of comprehensive hand sketches and 3D renderings will be used illustrate project details at different stages of development. This will in turn provide key stakeholders and the community with an accurate representation of how the skatepark will look and function within the Frank Brown Park site before moving forward to construction.



2. Context and Design Considerations: Creating a fully integrated park design that not only provides world-class skateboarding/BMX/scooter terrain but also enhances the site and respects the surrounding community will be a key focus of our design team. The Frank Brown Park site offers an exciting setting for the development of a truly inviting and unique all wheel park destination. However, along with the many contextual opportunities the location offers, several challenges may also arise that must be approached tactfully. Of significant importance will be working with the site's existing ground conditions, protection of the public and natural environment during construction, and ensuring a tactful integration of the skatepark with all surrounding multiuse amenities/areas (current and future).

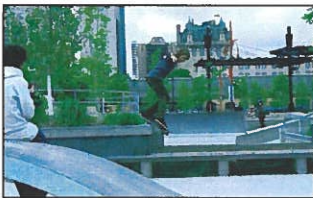

Bio Filtration and Sand Filtration Planters not only provide for creative LID storm water treatment but may serve as integrated skateable elements



Light-Weight Structural Styrofoam Sub Base
Queensborough All-Wheel Park - New Westminster, BC
and Seattle Center Skate Plaza - Seattle, WA

Geotechnical / Site Base Data - Our experience has shown that many sites can pose certain challenges to development due to the presence of unstable sub surface conditions that stem a variety of factors. Our team is well prepared for these type of challenges and has extensive experience designing and building over existing concrete foundations/slabs, contaminated sites, high water tables, flood plains and variable ground conditions within Bay County and across Florida. For each project's unique geotechnical and civil requirements, our team has employed an engineering process that draws on the skill and experience of our internal staff as well as the direction of local geotechnical engineers with relevant first-hand knowledge and expertise relevant to the ground conditions of Panama City Beach. We will ensure the entire team clearly understands the nature of the proposed facility and then jointly develop our final grading and drainage, base prep, and structural details for the park. For the new Frank Brown Park skatepark, our team will match a thorough understanding of geotechnical conditions with a full analysis of all existing civil infrastructure that may be eligible for tie-in with the new development. The result will be a final design plan that maximizes the potential of all suitable existing site infrastructure while mitigating any negative affects that potentially challenging sub surface conditions may have on the final budget and facility play value.



Use of recycled base materials



Soil analysis for biofiltration area



EcoSmart Concrete

Sustainable Development / Green Infrastructure / Protection of Public During Construction - Preserving natural and built environments will also be critical when we develop our plans for the site. Relevant ecological initiatives, surrounding vegetation, and the comfort of the public and nearby residents must be considered. Our team will ensure the park's design and construction documentation accounts for proper access of construction/maintenance traffic, proper treatment of storm water, tree protection, erosion and sediment control, and removal of unwanted materials in a way that minimizes undesirable impacts to the surrounding site area. We are proud to have introduced LID and 'green drainage' systems on a number of our recent skatepark designs and continue to participate in Leadership in Energy and Environmental Design (LEED) certified projects throughout North America. We look forward to providing our experience in this increasingly important area and offer the following sustainability practices that could be considered for the new PCB skatepark (note that this is not an exhaustive listing):

- Implement opportunities for onsite treatment of storm water through skateable biofiltration and sand filtration planters within skatepark hard surface and surrounding landscape ('green' storm water management system)
- Source locally produced granite for ledge applications
- Use of recycled concrete as potential skatepark sub base material
- Use of recycled steel in potential skateable sculptures
- Use of 'green friendly' or EcoSmart concrete and state of the art PLANT FIBER reinforcement in mix design
- Recycling of wood forming materials used in project
- Provide incentives for project staff to access work site by skateboard, bike, public transport
- Avoid unnecessary document printing related to project and use recycled paper whenever possible





Area Senior's capturing the action at a local skatepark

Most importantly, the new skatepark should be an inviting destination for all visitors and provide a true 'sense of place' for the community. With this in mind, it is important to not overlook the non-active user. They too must be welcomed into the site - to feel comfortable sitting down, watching or slowly walking by. For the primary users (skateboarders, scooter, BMX, etc.), their activity often happens in bursts and is not a continuous endurance session. Much of the time users are watching, socializing, and waiting for a turn. Thus, focusing on the whole of the site area and design components beyond the immediate function of the skate and bike park terrain will be critical. The following sections outline just a few elements that will be considered in this endeavor.

Safe pedestrian walk ways and viewing areas – Ensuring collisions/conflicts do not occur between skaters and casual visitors/bystanders will be important for setting the 'tone' for the park. Our team will work purposefully to design an overall layout and surface detail that will naturally direct activity to the appropriate areas without feeling contrived. We will ensure ample room for safe, unobstructed viewing and unfettered access around all key skatepark areas for the user and non-user alike. Existing area pathways and infrastructure will be analyzed, adjusted, and tied into the final design for eventual construction. We are confident that the new facility will provide a significant improvement in the overall accessibility and connectivity of Frank Brown Park.



Spectator overlooks and pedestrian promenades at The Plaza at the Forks

Landscape and materials detailing – focusing on the landscape design and materials detailing around the park will be important to a pleasant and subtle integration within the site. Our team will provide direction on green space forming and use of varied materials selections that create a vibrant and enduring setting. This will be balanced with our understanding of the construction budget, maintenance requirements, and usage realities of a high use public youth park. For the new PCB skatepark, special attention will be paid to utilizing a combination of appropriate local plant palette, pavers, steel and rock work options to create functional viewing, socializing, and shade areas in sync with the community's picturesque surroundings and unique character.



Diverse colours, textures and integrated landscaping

Art integration and theming – With a movement for greater integration of youth culture and contemporary activities into mainstream society and public spaces, we are beginning to look at skateparks differently. The days of the typical 'concrete square' are quickly coming to an end as a new generation of increasingly holistic skatepark designs respond to far more than purely function. A major part of this new design vision includes introducing art installations within and around the skatepark development. Our team has had the opportunity to spearhead this concept in North America and is excited with any opportunities the CPBC and local community may wish to pursue.



locally inspired skateable art installations at our Plaza at the Forks, Dickies Skate Plaza, UBC Skatepark, Roanoke Skatepark Carrington Covered Skatepark and Gilmanmax First Nation Skateparks

With a diverse site area, rich local culture and proud history, there will be ample opportunities for both skateable/rideable sculptures and other artistic elements. Whether it be referencing the community's breathtaking waterfront setting or more modern representations of Panama City Beach as a beacon for inclusivity and diversity, numerous ideas will surface for art installations that capture the City's 'spirit' and 'feel'. We look forward to engaging the community to help direct and determine the thematic structure and opportunities for art interventions within the skatepark's rideable footprint.

Our experience with the Plaza at the Forks in Winnipeg, MB is an excellent example of the integration of art and skate terrain. The design introduced locally created/inspired signature skateable sculptures and other art pieces from concept through completion into what would become a world-renowned public space. It was a process without precedent that has now given our team the unique advantage of understanding how to successfully engage local artists (and work within official City Art Programs), help choose submissions and oversee the transformation of artistic concepts to built installations that are both interesting and safe to skate. We have also acquired a keen understanding of the budget implications that come with each step in the process.



While our design team may have many ideas for compelling artistic themes and concepts, we want to be careful not to prescribe these to the project prior to hearing from public. Our experience has shown that many of the most exciting artistic solutions have been informed by local youth and community via our series of interactive design workshops and engagement events. Ideally, we want key stakeholders and the greater community to truly feel that they have provided meaningful creative direction on the final artistic themes and concepts.

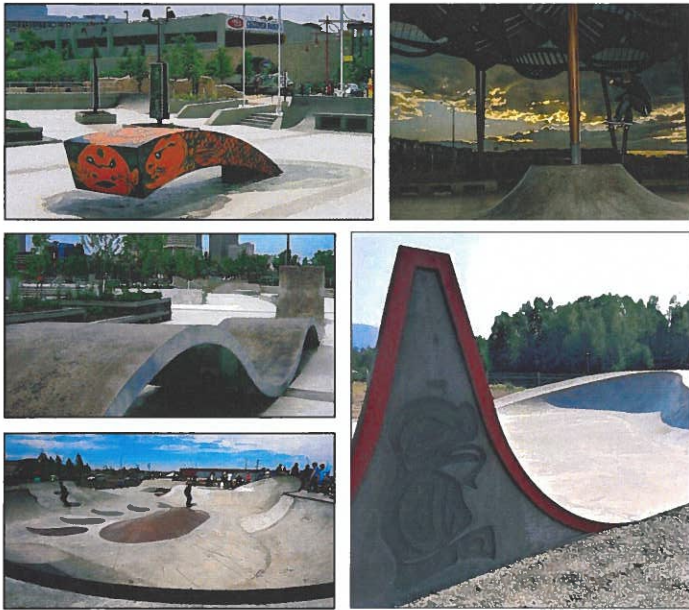

Skatepark Roof / Open Air Structures – Innovative architectural roof structures and creative park shelters have received considerable attention in the international municipal action sports park industry over the 5 years, and along with our leadership in the skateable art movement, our team has been honoured to introduce the first purpose-built municipal skate/bike park roof structures in North America. Starting with the Chuck Bailey covered youth park in 2011, and followed up with our landmark Cloverdale covered youth park in 2014, we were able to demonstrate the tremendous successful impact introducing compelling covered structures within the skate/bike park environment can have. This impact not only relates to facilitating safe skateboarding/bike activity in the park during inclement weather, but also for opening up opportunities for special events, shade, artistic installations, and servicing hubs (water, power, multimedia). Our unique experience with skatepark/bike park specific roof structures has provided our team with a rare ability to provide custom architectural installations that are functional within the context of a complex actions sports environment, visually striking, and cost effective. While perhaps not to the same scale as Chuck Bailey and Cloverdale, we look forward to potentially applying this skill and experience to the design-build challenge at Frank Brown Park to develop a creative open air structure that is 'uniquely Panama City Beach' (in terms of sustainable material use and architectural detailing) while also being cost effective and highly functional.



Covered structures from our Cloverdale and Chuck Bailey covered youth park projects



Site Servicing / Lighting – Site services engineering for any modern youth park is important and must be performed with consideration to future amenities as well as immediate usage requirements. *Our team is proud to have served as a pioneer in the development of skatepark specific photometric studies/ plans and are happy to present options for immediate or future implementation.* We have developed proven strategies to cost effectively implement optimal lighting programs in relation to specific user preferences, energy efficiency/conservation and neighborhood impact.

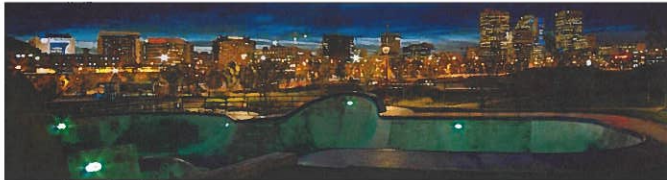

The challenge will be to develop and install a plan that meets the reality of the current budget and satisfies the desires of the Owner, park users and surrounding community. Our approach will be to communicate the available lighting choices for the specific requirements outlined in the RFP (photocell/motion activated with timer override, Dark Sky compliant), while also providing additional comprehensive lighting options for execution at the Owner's discretion. For the project at hand, we see a tremendous opportunity to include highly creative but cost effective artistic lighting accents in some of the signature skatepark features / skateable art installations. Whatever plan is implemented, it will be critical to consider the long term operation goals of the skate/bike park and ensure the initial scope of construction will accommodate any future lighting upgrades (if applicable).

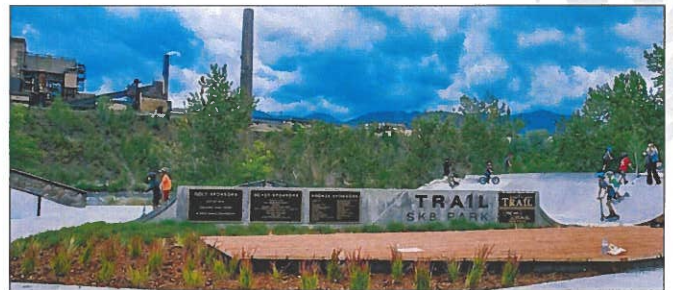

Site Signage – From recognizing project contributors to helping educating park visitors, signage may be an important item for the skatepark. Above are just a couple of examples of signage options from previous New Line projects that may serve as a base for this development. In many cases we have found great success with the use of highly durable concrete, granite/natural stone and steel materials combined with innovative molding and engraving techniques - all intended to be vandal resistant (through material impact density and graffiti abatement protection) and in most cases even rideable by skateboard, inline and BMX. Our team looks forward to presenting unique signage options for the CPCB's consideration.



CPTED (crime prevention through environmental design) – Throughout North America we have witnessed the tremendous effect that skatepark-specific CPTED planning can yield. Our team will consult with project stakeholders to identify current and potential crime and safety issues in the park and surrounding neighborhood, and design to mitigate the chance of their presence in the new development. Our experience with the Downtown Vancouver Skate Plaza (see picture and profile below) will also prove invaluable as the creation of the facility resulted in a major decrease in illicit activity in a trouble-ridden location – a true skatepark success story!



The Vancouver Skate Plaza successfully uses an under utilized scrap of industrial land under the Georgia Street viaduct and transforms it into an internationally recognized street-style skateboarding plaza. The design was developed in close partnership with the Vancouver Skate Coalition, the Vancouver Police Service, and surrounding community members through a series of interactive workshops and a custom online forum set up for ongoing stakeholder feedback. Key emphasis was placed on creating true 'urban form', maximizing available budget through creative use of existing site infrastructure and value engineering, identifying appropriate skateable and non-skateable access routes to and around the site, and the implementation of sound CPTED principles. Since its completion, the park has served as the basis for case studies across North America for the development of successful youth parks in areas undergoing urban renewal.

Canadian Society of Landscape Architects
Regional Honour Award

Skaters for Public Skateparks
Case Study - Success Project

Graffiti – hand in hand with CPTED principles is the common skatepark concern of graffiti. Despite the challenges this issue can pose, it is being addressed successfully by communities across North America through a combination of facility design techniques and park operating policies supported by the community. For graffiti, our team will work closely with the CPCB to explore an array of management techniques ranging from commissioned graffiti art programs to zero-tolerance policies involving mitigating graffiti through state-of-the-art liquid removal systems. We are proud to have consulted on some of the first successful community commissioned skatepark graffiti art programs in North America while also helping identify suitable 'cover-up' paint mixes and surface-safe steam/liquid removal systems for municipalities who have chosen to go graffiti free.

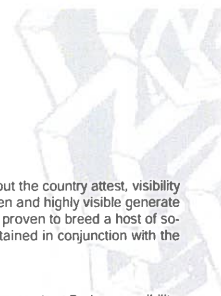

Park visibility must also not be overlooked. As countless communities throughout the country attest, visibility is a key component to the success of a modern youth park. Projects that are open and highly visible generate interest and engagement from the community, while those that are hidden have proven to breed a host of social problems. Our team will take care to ensure available sight lines are maintained in conjunction with the design of all concrete elements, land forming and planting.



Park Accessibility / Accessibility Requirements - Park accessibility must be considered when developing an inclusive public skateboarding/ BMX facility. Our team is no stranger to designing to various State and Municipal accessibility requirements and is currently working with compliance officials for many of our skateparks underway in multiple jurisdictions throughout Florida and across North America. This work has afforded us with an in depth understanding of the most recent public park accessibility considerations, which we will utilize as a base for the Idaho Springs Skatepark. However, our team desires to look beyond State regulations by exploring additional creative design options that will allow for an even more inclusive experience for disabled park visitors/ users (recognizing that a growing population of disabled visitors/ users will actually be riding the skatepark terrain).

At minimum, access to the skatepark facility will comply with Title II of the American Disabilities Act (which references municipal facilities, services and programs). Specifically, construction code 111.4.1 for Area of Sport and Activity accessibility requirements will be followed as a starting point. Examples include: access ways that may include ramp grades and landings, pathway widths, transition and letdown points, bollards, access to amenities such as picnic tables, benches, and resting areas to the perimeter of the active user space. In the skatepark user space itself, the design will include designated standing and gathering areas with strict adherence to fall height requirements and requirements for guardrails or barriers to prevent falls to the outside of the riding zone.

Visually Impaired Professional Skateboarder and Adaptive Design Consultant, Dan Mancosa riding New Line Skateparks' LaGrange Community Skatopark - LaGrange, GA





3. Technical Design and Working Drawings The technical drawings for this unique project will be of critical importance. Our team takes this task very seriously and we challenge ourselves to create informative, illustrative, and comprehensive drawing packages. Our goal is to eliminate all ambiguity in the project specifications to help ensure a very clear approval and construction process.

Our ability to deliver industry leading drawing packages stems largely from our experience from both a consultant and contractor's standpoint. New Line Skateparks is one of the most experienced concrete skatepark specific design-build teams in the world. **Over the past decade, we have built out a large proportion of our 450+ skate and bike park design projects through our own fully bonded and insured construction teams.** The constant exposure to both realms of project management allows us to quickly improve/refine our drawings and communication strategies in response to field problems/issues on an ongoing basis. Essentially, as we design we also understand intimately what it will take to execute in the field. This heightened knowledge allows us to stay on budget and deliver final designs as they were intended - not as near replicas. This is another competitive advantage of our team and a major reason for our award winning facilities.

All drawings will be generated and engineered 'in-house', allowing for a seamless stream of communication within our development team. Review sets of all plans (including a comprehensive storm water management plan) will be provided at various stages of completion for approval by the project owner and the appropriate regulatory bodies. Upon final red line review and approval, all skatepark specific drawings and specifications will be issued for construction. To date, our custom drawings and specifications have been approved for implementation across North America. Errors and Omissions insurance of \$2,000,000 (specifically covering concrete skate/bike park design) will accompany each final drawing submission.

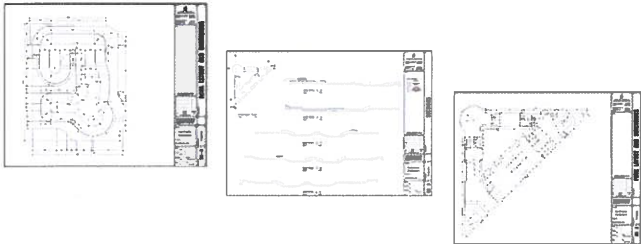

4. Construction Once the design drawings have been converted into technical details the park must be built. For this important responsibility, New Line Skateparks Inc. is excited to offer one of the longest running, most experienced and highly recognized concrete youth/skatepark construction teams in North America. Our team has worked hard to earn this industry reputation over the last 23 years.

Construction Staff - Skate/bike park construction is a very technical and specific art form that requires the proper care and precision to 'get it right'. Crew members must not only possess highly specialized concrete construction expertise but also have a comprehensive understanding of the skatepark user groups and their activities. Our team consists of approximately 40 full-time highly trained and accredited concrete construction specialists (including 3 ACI trained shotcrete nozzlemen), most of whom are also active recreational and/or competitive skateboarders, BMX bikers and parents of middle school children. Under the leadership of Kyle Dion and Trevor Morgan, some members of this crew have worked together since the company's inception (23+ years), resulting in an extremely efficient and experienced proven core team with an unmatched level of top-rated municipal concrete skateparks to their credit.

Construction Compartmentalization - The term 'construction compartmentalization' simply refers to the division of the skatepark project into manageable units. We do not tolerate cost/schedule cutting through the use of massive concrete pours. We prefer instead to pour panels within manageable dimensions that allow experienced finishing crews to spend time 'polishing' and 'smoothing - out' the finished surface. The first panel poured should resemble the last, thereby providing a uniform surface across the park.



CNC Form Fabrication and Custom Finishing Tools - To further ensure all concrete elements are completed accurately to the set design specifications, New Line Skateparks Inc. has access to a custom fabrication facility equipped with Computer Numerical Control (CNC) technology. The shop prepares complex forming packages and custom concrete finishing tools required for each unique project. The specially fabricated forms and tools allow for a significantly higher degree of terrain accuracy and quality throughout each park while providing heightened efficiency and cost savings by virtually eliminating the majority of arduous onsite form preparation (typically 2 - 3 weeks). The CNC form and tool system is proprietary to New Line Skateparks and has been the result of years of testing on projects across the globe.



BMX Reinforced Coping / Custom Edge Detailing - With the range of users taking advantage of the new recreational opportunities afforded by youth parks, we have seen some challenges to strong construction and durability. Skateboards, bmx, and inline, all have an impact on the park and it is critical to provide a 'heavy-duty' finish so that the park maintains a safe and 'new' feeling for many years. One of the main issues related to park degradation is weak edges. These edges exist on all concrete features, either at coping or on steel edged ledges.

One "optional" innovation that was brought about due to concrete damage from bmx 'pegs' was the alteration of our coping detail. We now utilize heavy gauge steel plates welded to the top of coping (with the appropriate offset for 'locking-on'), set flush in the outer deck of the park. This detailing is used exclusively by our team and provides a consistent and heavy wear plate for the extended pegs of modified bmx. This innovation does not affect the skateability of a park, but enhances the long-term wear of the concrete.

Another innovation in edge detailing is the use of custom poured concrete edges. The construction team prepares a number of forms that replicate the concrete edges of surrounding seat walls and ledges. These 'concrete coping' elements are bolted into place where traditionally we have placed steel edging. This element provides a true 'street' feel. Skaters have commented that they appreciate some elements within the park that allow them to have a true concrete grind edge. This concrete element can be changed after a period of heavy wear, without large cost or time expenditure. The result is a park that feels 'new' for an extended period of time.



Concrete Mix Design and Reinforcement - While the skatepark must be formed, shaped, and finished correctly, it is critically important not to overlook the intricacies of effective concrete mix design and reinforcement specifications. As one of the Country's longest running municipal concrete skatepark builders, New Line Skateparks brings nearly 23 years of proven skatepark-specific concrete mix design and reinforcement research and field testing to every project undertaken. *Each specialized concrete mix design variation and associated steel reinforcement specification has been developed with feedback from multiple engineering disciplines, ready-mix suppliers, and ACI / ASA certified concrete consultants, and will be tailored to each skatepark's unique terrain elements (ie. flat vs ledge, vs. bank vs transition vs oververtical), site-specific engineering recommendations, and regional aggregate properties.* The result will be a final skatepark facility with superb concrete durability and performance specific to local climatic conditions in Panama City Beach. Our continued leadership in the field of skatepark-specific concrete mix design and reinforcement technology is a major reason our team has earned the trust of communities across the Continent.

All Weather / Winter Construction - Our team is no stranger to difficult work conditions and demanding time lines. With many municipalities facing increasingly stringent grant requirements and ambitious community expectations related to project schedule and budget, we have responded with the development of specialized tools and procedures that will minimize risk of project weather delay. This includes the use of a specialized series of concrete shelter systems as well as other industry best practices for architectural concrete works under inclement weather conditions. Our success in this area has made us one of the most sought after construction teams for time-sensitive and off-season projects.





Community / local business participation / youth mentorship and work experience programs - Truly successful skateparks have proven to be the result of active involvement from individuals across the entire community. This is true in relation to gathering input during the design process but often also throughout the execution of the park's construction. Our team welcomes the participation of community members and neighborhood businesses throughout project's duration in both a paid and volunteer/donation capacity. From past experience, we know that many landmark projects would not be possible without this consideration.

Please see the following information on our approach to accommodating various donations and keeping project monies within the community by retaining local businesses to assist with project work.



local company, MD Landscaping, assists with excavation and grading in Cochrane, AB

community volunteer and skatepark work experience program at Mount Nelson Skatepark - Invermere, BC



Donations in kind... Donations of cash and materials/labor in kind from the community may be contributed to this project during design development and at various points throughout construction. Our team welcomes select donations of materials and labour at a reasonable market value. Each donation will be reviewed and discussed with the project owner and a value will be set prior to accepting. Each contribution will result in a contract credit or addition to the park development. These additions may include extra square footage, park amenities, additional landscaping, etc. Our team will work closely with the CPCB in exploring major in-kind donation options - especially opportunities in the areas of concrete supply, fill material, excavation machine time, landscaping supply, site fencing, iron works, etc. In past projects we have seen some of these items contribute to up to a third or more of the overall project budget!

Paid Participation... Although concrete youth/skatepark construction is a highly specialized field involving unique equipment and personnel, there are still many opportunities for local businesses to assist with paid scopes of work for the Panama City Beach project (we want to keep as much of the skatepark construction budget possible within the community). Below are materials, equipment and labour our team will seek to source in Panama City Beach (these items may also serve as eligible in-kind donations):

- Excavation machinery and civil works services/contractors
- Trucking / shipping
- Structural fill materials
- Drainage materials
- Rebar
- Lumber
- Concrete supply and pumping
- Overnight site security during critical pours
- Landscaping services and materials
- General labour for basic site assistance

Safety – Safety of our crews and the community from project start to finish is paramount to our team. Over the past 22 years we have developed a comprehensive OH & S compliant safety plan designed to protect our crews and the public throughout the construction process. Success with our safety program is evidenced by a clean track record with Workers Compensation and zero formal infractions issued by any state safety regulatory body to date. We look forward to continuing safe operations for the City as an official Certificate of Recognition (COR) accredited company. New Line Skateparks was the first concrete skatepark specific design-build team in North America to hold this advanced standard of construction safety certification. We look forward to submitting our detailed safety plan for the CPCB to review prior to construction start-up.



Workplace Safety Certificate of Recognition

5. Overall Quality Control - New Line Skateparks has established design and construction operations that are in general compliance with ISO 9001 quality assurance measures and environmental policies in general compliance with ISO 14001. Our team will provide timely reports on project progress for compliance to specifications and client expectations. Detailed reports will be provided to the owner's representative to ensure that schedule, budget, and deliverables are met. If the Owner has specific questions related to progress, schedule, or quality, our team of professionals will investigate and respond in a timely fashion. Our team uses ISO 9001 standard protocol for project documentation and reporting. The Owner can expect clear, concise, and professional documentation of project progress so that reports can be made to other senior staff, specific departments, or political constituents.

Budget Control - Our team is a national leader for concrete skatepark design, technical detail development, and construction. Because of our intimate knowledge of this style of project development, we are collectively involved with approximately 35 new concrete youth parks every year. This involvement in a variety of jurisdictions has given us a unique perspective on costing trends and projections throughout Florida and across the continent. Our in-house senior quantity survey team has worked on over 450+ construction sites for skatepark development and we bring an unparalleled understanding of the issues that affect concrete skatepark construction costs. Our team has full confidence in our ability to deliver a final design and construction program that will demonstrate exceptional value for the CPCB and remain on-budget in accordance with the original project parameters. We look forward continuing this track record of budget certainty during this project with a final detailed construction cost breakdown submitted for approval prior to construction start-up.

Schedule Control - From our experience working on ~450 similar facility developments across the continent, our team is confident that the schedule outlined within this proposal is both reasonable and achievable. A final project timeline will be confirmed (and adjusted if desired) with the owner prior to start up and reviewed on a weekly basis by the consulting team to ensure key milestones are being met within set time allowances. Should a schedule deviation occur, all parties will be notified immediately with a discussion on project implications and mitigation options taking place thereafter.



6. Warranty and Post Occupancy Support - Having the appropriate checks and balances is important for any large construction project. The development of the new Panama City Beach Skatepark will be no different in this respect. Our team will be available to commission a series of testing over the project's course including fill compaction as well as various concrete mix design, slump, and cure tests. In addition, we will work with the Owner to create an open schedule of inspections by the appropriate municipal staff and local regulatory bodies. This will then be backed by our 2 year *warranty* program with regular review inspections conducted by senior staff from our Florida base (warranty period may be extended subject to negotiation and associated bonding costs).

Prior to opening our crews will also conduct a *maintenance and care seminar with appropriate City Staff*. This will include an onsite 'hands on' session covering typical maintenance and operations procedures. Finally, a comprehensive park *operations and maintenance manual* will be provided for reference, and we are always available for assistance with our parks at anytime.

As much of the park will be constructed highly durable municipal grade concrete based on the best practices of our 23 year industry tenure, the facility will require relatively minimal maintenance over the expected 35+ year life span. That said, we encourage our clients to engage in regular inspections and some level care for the park each season.

PAGE INTENTIONALLY LEFT BLANK

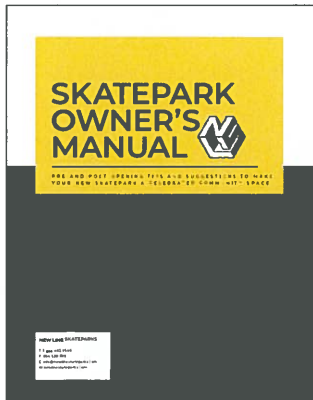



METHODOLOGY AND SCHEDULE

The following pages reflect our detailed work plan and project schedule. While we are confident in the rationale for our methodology, our team is always open to adjustments in cooperation with the City to best serve the project. We have been careful to monitor our company growth and workload over the last two decades and offer our full confirmation that our team (~75 full time staff) has the availability, and specialized resources required to execute this special community project within the schedule parameters outlined. Our project commitment involves a highly responsive, in-person consulting presence and interaction with the City and community, taking advantage of our history of work in the immediate area and our intimate understanding of the design-build challenge that lies ahead.

Phase 1: Site Analysis, Community Consultation and Concept Design

Task	Specific Objective	Timeline/Deliverables
1.	<p>Project Initiation, Program Review and Site Base Data Collection</p> <p>The Design-Build Team will meet with the City to review the intended program for the skate/bike park development. At this time, project goals and objectives will be confirmed, work plan steps and schedule milestones reviewed, lines of communication established (including a suggested bi-weekly update meeting day and time), and key design and engineering parameters verified. Focused time will also be reserved to discuss our proposed approach to the key stakeholder and public engagement process.</p> <p>The Design-Build Team will then work with the City to review all on hand base data for the site. This will include all relevant planning documents and development guidelines, existing GIS information, and other pertinent data related to grades, irrigation, existing vegetation, current and future site development. This information (along with our separately commissioned site survey and geotechnical study) will contribute to the base for all future planning and design work.</p> <p>We will conclude the Initiation session with a thorough 'walkthrough' of the project site with City staff to discuss existing conditions and other key context-driven development considerations.</p>	<p><i>Week 1 (Upon Award)</i></p> <p>Meeting minutes key contact information</p> <p>Project Journal initiated</p> <p>Proposal concepts and budget reviewed</p> <p>Project safety, environmental and quality assurance plan submitted</p> <p>Geotechnical Study and Site Survey Initiated</p>
2.	<p>Create Base Maps and Site Analysis Drawings</p> <p>Using information gleaned from task one, the design team will prepare base maps from which all future design work will be based. This is critical to ensure that design development adheres to an accurate site specific data set and the design team does not encounter unexpected site conditions later in the technical design phase.</p>	



Phase 1: Site Analysis, Community Consultation and Concept Design...

Task	Specific Objective	Timeline/Deliverables
3.	<p>Skateparks 101 Community Participatory Design Workshop 1</p> <p>Prior to engaging in conceptual design development, the consulting team will conduct a community project information session and design workshop. This ~2hr session usually takes place in the early evening at a time convenient to both parents and youth. The workshop will begin with a presentation introducing the project team and objectives, an overview of the skatepark development journey, and an exciting case study based review of modern concrete skateparks and the activities they facilitate (our internationally recognized 'Skateparks 101' presentation). Once attendees are familiarized with the project parameters and vast array of skatepark improvement/expansion possibilities / options, the workshop will then transition to a comprehensive, 'hands-on' component consisting of a 'dotmocracy' exercise, interactive drawing/sketching, writing, discussion, modelling of specific park layout/features, and site integration options (<i>note that the preliminary/sample concept directions submitted in this proposal may be also be referenced as a starting point for this exercise</i>)</p> <p>The workshop will conclude with a general summary of the input received and the collection of all participant sketches and feedback forms. Attendees will be encouraged to continue submitting ideas and comments through our custom online survey until such time that the design team returns for the next community design workshop.</p>	<p><i>Week 3</i></p> <p>Prepare and conduct workshop</p> <p>Minutes and summary report of workshop submitted to Owner</p> <p>Online forum open for continued feedback.</p>
4.	<p>Begin Development of Alternate Design Concepts</p> <p>The consulting team will tabulate information from the first participatory design workshop and initial key stakeholder meetings to begin developing concept directions. Our experience has shown us that one dominant design detail will begin to emerge through this process, although we will offer a couple concept options for feedback. Our team is prepared to provide design for all aspects of the surrounding site area as highly integrated design approach.</p>	<p>Workshop feedback tabulated into spreadsheets, written summary, and presentation graphics for Owner and Public review. In-progress design sketches provided to Owner and posted online for continued feedback.</p>
5.	<p>Internal Review of Preliminary Budget Concept Options</p> <p>The consulting team will meet with the City to review the concept development progress and discuss budgetary issues. The designs will continue to be refined and the cost implications of the preliminary concept(s) will be evaluated in preparation for presentation to the public</p>	<p><i>Week 8</i></p> <p>2D concept drawings and preliminary cost estimates reviewed with City</p>



Phase 1: Site Analysis, Community Consultation and Concept Design...

Task	Specific Objective	Timeline/Deliverables
6.	Presentation of Preliminary Concepts - Community Design Workshop 2 Comprehensive 2D renderings of the preliminary concept design options will be brought back to the community for feedback through a second interactive design workshop on a weekday evening convenient for parents and youth. The concept presentation will consist of a PowerPoint aided overview of the development process to date, a discussion of the guiding principles established at the first participatory workshop, and a thorough review of the site-specific concept design(s) developed for the skatepark expansion/improvements. This will be followed by a general Q&A session and opportunity for attendees to vote (via feedback forms and online survey) on the preferred concept directions + submit suggestions for any final modifications of the final concept design.	<i>Week 9</i> Prepare and conduct workshop 24" x 36" presentation panels of 2D skatepark concept renderings. Concepts will be posted to online forum for continued voting.
7.	Preparation of Preferred Concept Design and Review with City Detailed 3D renderings and updated cost information of the preferred concept will be prepared and then reviewed with the City for comment and feedback.	<i>Week 12</i>
8.	Presentation of Preferred Concept - Community Design Workshop 3 Comprehensive photorealistic 3D renderings of the preferred concept design will be brought back to the community for any final feedback through a third interactive design workshop. The final community concept presentation will consist of a PowerPoint aided overview of the development process to date and a thorough review of the final concept design developed for the skatepark. This will be followed an opportunity for attendees to provide any last comments for consideration in written feedback forms.	<i>Week 13</i> Prepare and conduct workshop 24" x 36" presentation panels of 3D skatepark concept renderings.
9.	Submission of Final Concept Design and Phase 1 Summary Report Any modifications as a result of the final community concept design review will be prioritized for implementation and work will begin on the final concept adjustments in conjunction with the City. We will update our plans so that the preferred park concept is fully dimensionally correct and technical drawings can proceed with ease. The final park concept and Phase 1 summary report will be submitted to the City and we will be available to conduct any final presentations to relevant parties as required.	<i>Week 14</i> Final concept design renderings and conceptual cost estimate+ Phase 1 summary report.

Phase 2: Technical Design and Construction Drawings

Task	Specific Objective	Timeline/Deliverables
1.	Begin Working Drawings and Specifications and Permit Applications We will begin work in earnest to complete the technical specifications and working drawings for the youth park project. We anticipate a time frame of 3 weeks until we can submit 60% drawings for discussion and review with City Staff.	<i>Week 15</i>
2.	Complete Construction Drawings Reviews The technical design team will complete all construction detailing, construction documents and specifications for the skatepark project. Drawing sets and cost estimates will be sent to the City and relevant local and State approval bodies for full red line review and approvals at 60%, 90%, and 100%. Update meetings to review and approve potential in-kind donations will also be conducted at each drawing review milestone.	60%, 90%, and 100% complete drawings, and cost estimates
3.	Delivery of Final Construction Drawings Any last amendments will be included in final construction documents and specifications. Final sealed IFC drawings, specifications, and GMP budget package will be sent to the Owner in accordance with the desired file scheme. Any changes made during construction will be provided via 'as built' drawings upon completion.	<i>Week 21</i> Copies of IFC drawings package, specifications, and final budget delivered to Owner in CAD and PDF formats

Phase 3: Construction

1.	Construction Mobilization The construction team will meet with City to review the priorities for park construction and a detailed schedule for completion of key milestones within each phase of construction. Our key COR (Certificate of Recognition) site safety policies, environmental program, and ISO 9001 generally compliant construction quality assurance measures will also be confirmed at this time. We will also work with the City to physically verify the site fencing, construction access and staging areas, and traffic control realities.	<i>Week 1</i> (Exact Summer/Fall 2024 Construction Start Date TBD with CPCB) Weekly meeting date with Owner set. Construction progress meeting minutes to be submitted weekly.
-----------	---	---



Phase 3: Construction...

Task	Specific Objective	Timeline
2.	Layout, Demolitions and Site Preparation The construction team will layout all design grades, complete all required demolitions and removals, and prepare the site for grading and drainage.	<i>Week 1</i>
3.	Grading & Drainage The construction team will proceed with installation of the drainage system. Any required site servicing (including conduit and lighting pole bases) will be roughed into the park area at this time. Base skatepark design grades will then be established.	<i>Week 3</i>
4.	Fine Shaping / Banks & Transitions Once the rough grades are established and the drainage is installed, we will proceed with fine shaping of the park elements. The park construction team will then assess the weather forecast. If weather is favourable for pouring concrete, our team will proceed with installing the banks and transitions. All banks and transitions are poured in small, controlled panels to ensure proper shaping and finishing.	<i>Week 5</i>
5.	Flat Slabs Once all banks and panels are complete the construction team will prepare, form and pour the base slabs. These sections will require favourable weather as they are larger pours.	<i>Week 9</i>

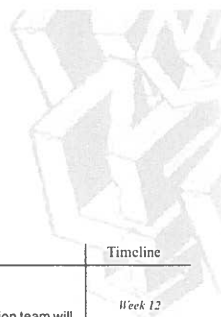

Phase 3: Construction...

Task	Specific Objective	Timeline
6.	Ledges & keystone features Upon completion of the banks, transitions and flat slabs, the construction team will proceed with forming and pouring all ledges and keystone features.	<i>Week 12</i>
7.	Finishing Landscaping / Lighting / Support Amenities Once all concrete is completed and the park is cleaned and ready for use, our team will coordinate all landscaping, lighting and support amenities installation.	<i>Week 14</i>
8.	Clean Up / Demobilization / Project Close-Out and Facility Grand Opening Upon completion of all construction works, our team will remove debris and prepare the park for public use. Prior to opening our crews will also conduct a <i>maintenance and care seminar with appropriate City Staff</i> . This will include an onsite 'hands on' session covering typical maintenance and operations procedures. As-built drawings will be submitted and our warranty program will be initiated. Finally, at New Line Skateparks, we also take pride in participating in the skatepark opening ceremony and dedication events by helping organize professional skateboarding talent and prizes for the community. We are committed to employing our full resources for completion of the project in a timely manner to maximize community use for the season. Construction of this community scale park is expected to take approximately 18 weeks from mobilization. It is our intention to work efficiently until project completion. Should severe weather alter our work program, we will adjust our schedule to ensure quality control.	<i>Week 18</i>

PCB SKATEPARK DESIGN-BUILD



Proposed Project Schedule

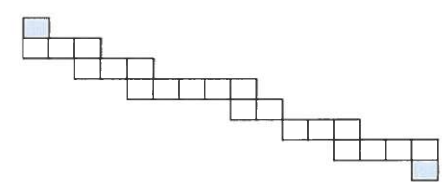
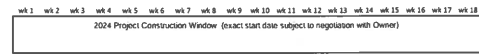
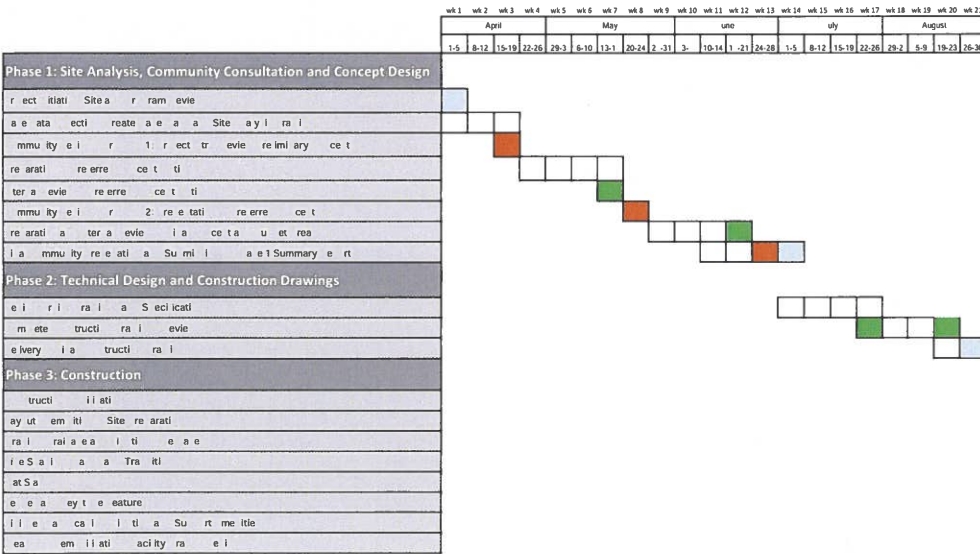

FRANK BROWN PARK SKATEPARK

SAMPLE CONCEPT EXPLORATION #1

CONCEPT OVERVIEW

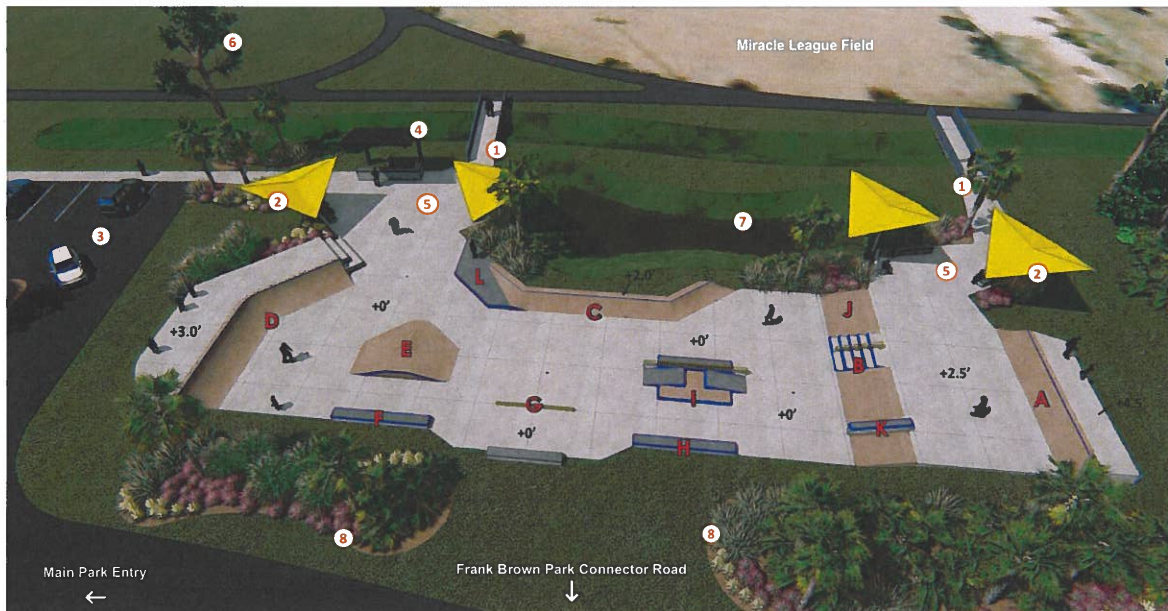

SITE PLAN LEGEND

SKATE FEATURES

- A** 2-foot Quarter Pipe Wall
- B** 5-stair with Centered Handrail
- C** China Bank Wall with Hip
- D** 3-foot Quarter Pipe With Pocket
- E** Hipped Pyramid
- F** 12" High Ledge
- G** Round Flat Bar
- H** 14" High Ledge
- I** Combo Island - Kickers, Out-rail, Manual Pad
- J** Long Bank Wall
- K** Bank Wall With Double Side Hubba Ledge
- L** 10" High Ledge / Manual Pad

SITE AMENITIES & FEATURES

- 1** - Pathway Connections to Existing Bridge(s)
- 2** - Shade Canopies with Seatwalls Below
- 3** - Planned Parking Lot
- 4** - Shaded Concession Area
- 5** - Pedestrian Entry & Spectator Plazas
- 6** - Preserved Existing Pine Tree
- 7** - Detention Basin with Overflow Structure
- 8** - Mulched Planting Areas



The following preliminary design directions illustrate 1 of countless stylistic approaches and terrain assortments that could be pursued in some form for the Frank Brown Park Skatepark. Included in this direction, is a versatile selection of highly accessible site-built concrete street-style features tactfully tied into the surrounding landscape. Hardsurface terrain elements will be complimented by numerous safe and inviting viewing areas, possible biofiltration storm water management zones, strong connections to surrounding pathways, and opportunities locally inspired skateable art installations. Creative saw cut floor patterns, integral colour concrete, a custom community logo inscription, and an integrated entry sign will introduce the skatepark to all visitors. *Note: skatepark size dependent on confirmed civil approach, final geotechnical details, and the landscaping + amenity specification desired by Owner. Final design will also be informed by our in-depth consultation process with the Owner and community.*

PANAMA CITY BEACH, FL

MARCH 2024

WWW.NEWLINESKATEPARKS.COM

FRANK BROWN PARK SKATEPARK

SAMPLE CONCEPT EXPLORATION #1

BIRD'S EYE VIEW OF SKATEPARK



ADDITIONAL PERSPECTIVE VIEWS



PANAMA CITY BEACH, FL

MARCH 2024

WWW.NEWLINEKATEPARKS.COM

FRANK BROWN PARK SKATEPARK

SAMPLE CONCEPT EXPLORATION #2

CONCEPT OVERVIEW

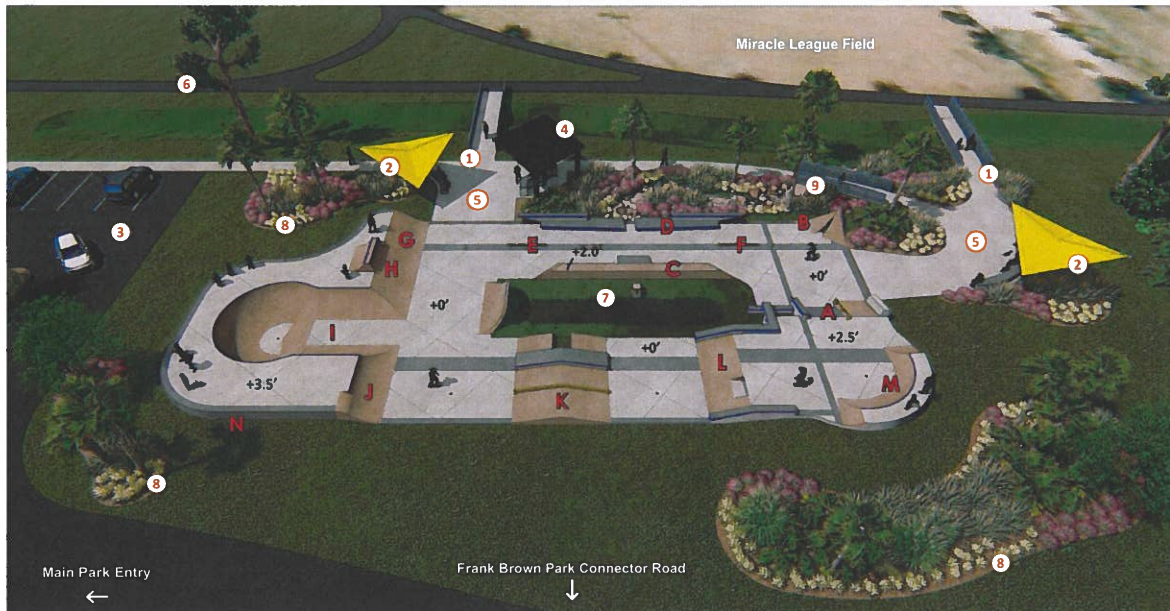

SITE PLAN LEGEND

SKATE FEATURES

- A** 5-stair, Out-Ledge, Gap, Rail & Hubba
- B** Cantilevered Sculptural 'Sails' Bank
- C** China Bank Wall with Hip & Inset Ledge
- D** Mirrored Manual Pad & Ledge Combo
- E** Square Flat Bar
- F** Round Flat Bar
- G** Long Bank Wall
- H** Bank to Barrier
- I** Multi-level 3/4 Transition Zone
- J** Quarterpipe Wall with Roll-in
- K** A-frame with Ledge, Rail & Gap Combo
- L** Bank and Step-up Gap Combo
- M** Mini Transition Pocket
- N** Potential Turndown Wall Signage Location

SITE AMENITIES & FEATURES

- 1** - Pathway Connections to Existing Bridge(s)
- 2** - Shade Canopies with Seatwalls Below
- 3** - Planned Parking Lot
- 4** - Shaded Concession Area
- 5** - Pedestrian Entry & Spectator Plazas
- 6** - Preserved Existing Pine Tree
- 7** - Detention Basin at Center of Skatepark
- 8** - Mulched Planting Areas
- 9** - Planted Bioswale & Pedestrian Bridge



The following preliminary design directions illustrate 1 of countless stylistic approaches and terrain assortments that could be pursued in some form for the Frank Brown Park Skatepark. Included in this direction, is a versatile selection of highly accessible site-built concrete street-style features punctuated by a central 'green island'. Hardsurface terrain elements will be complimented by numerous safe and inviting viewing areas, possible biofiltration storm water management zones, strong connections to surrounding pathways, and opportunities locally inspired skateable art installations. Creative saw cut floor patterns, integral colour concrete, a custom community logo inscription, and an integrated entry sign will introduce the skatepark to all visitors. *Note: skatepark size dependent on confirmed civil approach, final geotechnical details, and the landscaping + amenity specification desired by Owner. Final design will also be informed by our in-depth consultation process with the Owner and community.*

PANAMA CITY BEACH, FL

MARCH 2024

WWW.NEWLINEKATEPARKS.COM 189

FRANK BROWN PARK SKATEPARK

SAMPLE CONCEPT EXPLORATION #2

BIRD'S EYE VIEW OF SKATEPARK



ADDITIONAL PERSPECTIVE VIEWS



PANAMA CITY BEACH, FL

MARCH 2024

WWW.NEWLINEKATEPARKS.COM

FRANK BROWN PARK SKATEPARK

STORMWATER MANAGEMENT APPROACH

SAMPLE CONCEPT #1 - STORMWATER & DRAINAGE APPROACH

SAMPLE CONCEPT #2 - STORMWATER & DRAINAGE APPROACH

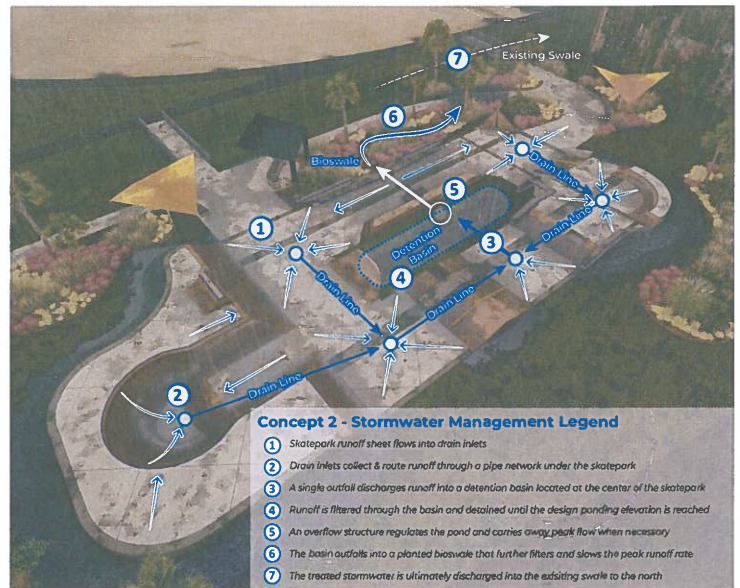
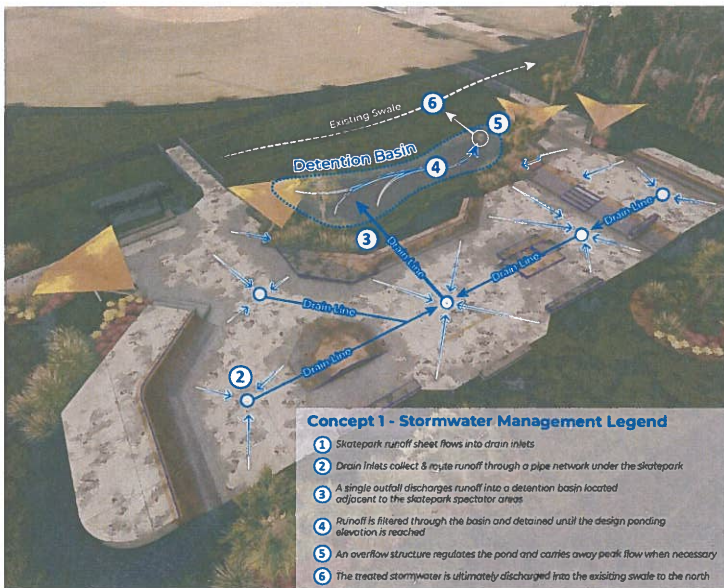

Stormwater & Drainage Notes:

- Preliminary calculations show that the proposed development will produce approximately 8,500 CF of runoff in a 25-year design storm. Storage volume of detention features shown on the sample concepts shown exceed this figure.
- Conceptual drainage approach assumes existing patterns discharges into the existing stand of trees to the east. These approaches can be adapted to confirmed conditions during technical design.
- Detention basins shown assume that a metered outlet structure would be required but also that native soils will allow for some level of infiltration.
- Water table elevations in this region are typically shallow. The skatepark baseline elevation may need to be elevated to accommodate this factor.

PANAMA CITY BEACH, FL

MARCH 2024

WWW.NEWLINESKATEPARKS.COM

KNOWLEDGE OF SITE AND LOCAL CONDITIONS +
REFERENCES





KNOWLEDGE OF SITE AND LOCAL CONDITIONS

New Line Skateparks and our extended project team's experience working within Panama City, the greater Bay County and throughout Florida's coastal communities has given our team an exceptional understanding of local conditions as well as the unique considerations that will affect the design and construction program for the project at hand.

Stormwater management in the area will be of critical importance and our team has an extensive understanding of regional drainage patterns / drainage concerns that could affect Frank Brown Park and the identified project site. An existing drainage channel crosses from west to east along the north end of the project site, which we anticipate will act as the stormwater outfall for our skatepark. As part of the conceptual stormwater design, we will identify the point of discharge, tailwater conditions, preliminary site grading, preliminary stormwater runoff collection and conveyance to an agreed upon stormwater management facility. If a new stormwater management facility is required, the results of our geotechnical soils evaluation will dictate the type of stormwater treatment system applicable to the project site.

FDEP/NWFWMR ERP Permit – It is anticipated that an Environmental Resource Permit (ERP) will be required for the project. Site engineering plans and stormwater report will be submitted to the applicable agency for review and permit approval and our experience in the region will ensure coordination and communication with the agencies will be timely and efficient.

City of Panama City Beach Development Order – Site engineering plans and reports will be submitted to the Planning Department, Public Works Department, and Utility Department for review and approval of site improvements, accessibility, site grading, utilities, and stormwater drainage.

FDEP Wastewater Permit – According to city utility base maps, it appears gravity sanitary sewer is not available adjacent to the site. If a services concession is ultimately included the project, it is assumed that grinder pump station will be utilized for wastewater service. If a pumped wastewater system is required, site engineering plans and report will be prepared and submitted to the City Utility Department and FDEP for review and permit approval.

FDEP NPDES – The project site identified for our work is noted to be approximately 22,250 square feet. Since the project site will be less than 1-acre, FDEP NPDES stormwater discharge permit will not be required for the project. Regardless of no permit required for a project site under 1-acre, the construction plans will include stormwater pollution prevention and best management practices to control sediment discharge generated by construction activities.

Having constructed our Bonita Springs Skatepark during Hurricane Ian, our team is also no stranger to designing and constructing in Hurricane-affected areas. Design-build detailing for high winds (~13 projects in 140 - 150mph wind zones), low elevations (~20+ projects with ave elevations under 7' above sea level) and other Hurricane risks is simply part of our approach to working in Florida's coastal areas.

Finally, the **safety of community and our crews from project start to finish is paramount to our team. Over the past 23 years we have worked on over 400+ sites that have included contexts and nearby amenities similar to those present in Frank Brown Park.** Success with our safety program is evidenced by a clean track record with Workers Compensation and zero formal infractions issued by any State safety regulatory body to date.



REFERENCES

PCB24-25 RFQ – SKATE PARK DESIGN-BUILD SERVICES

REFERENCES FORM

Bidder shall provide a minimum of three references, for which they are currently providing a similar service/commodity of size and scope for Government agencies.

- Client: City of Panama City Contact: Kesia Milner kmilner@pcgov.org
Job Name: Downtown Panama City Skatepark (design-build)
Job Start Date: Spring 2020 Job Completion Date: Fall 2020
- Client: City of Lenexa Contact: Logan Wagler lwagler@lenexa.com
Job Name: Rolling Magic Skatepark (design-build)
Job Start Date: Spring 2022 Job Completion Date: Fall 2023
- Client: City of Newnan Contact: Cleatus Phillips cphillips@cityofnewnan.org
Job Name: CJay Smith Skate Plaza and Pump Track (design-build)
Job Start Date: Fall 2020 Job Completion Date: Summer 2021
- Client: City of Bonita Springs Contact: Nicole Perino nicole.perino@cityofbonitasprings.org
Job Name: Bonita Springs Skatepark (redesign and construction)
Job Start Date: Fall 2022 Job Completion Date: Spring 2023
- Client: City of Greeley Contact: Andy McRoberts andymcroberts@greeleygov.com
Job Name: Greeley Skatepark Network (3 parks, design-build)
Job Start Date: Winter 2018 Job Completion Date: Spring 2020

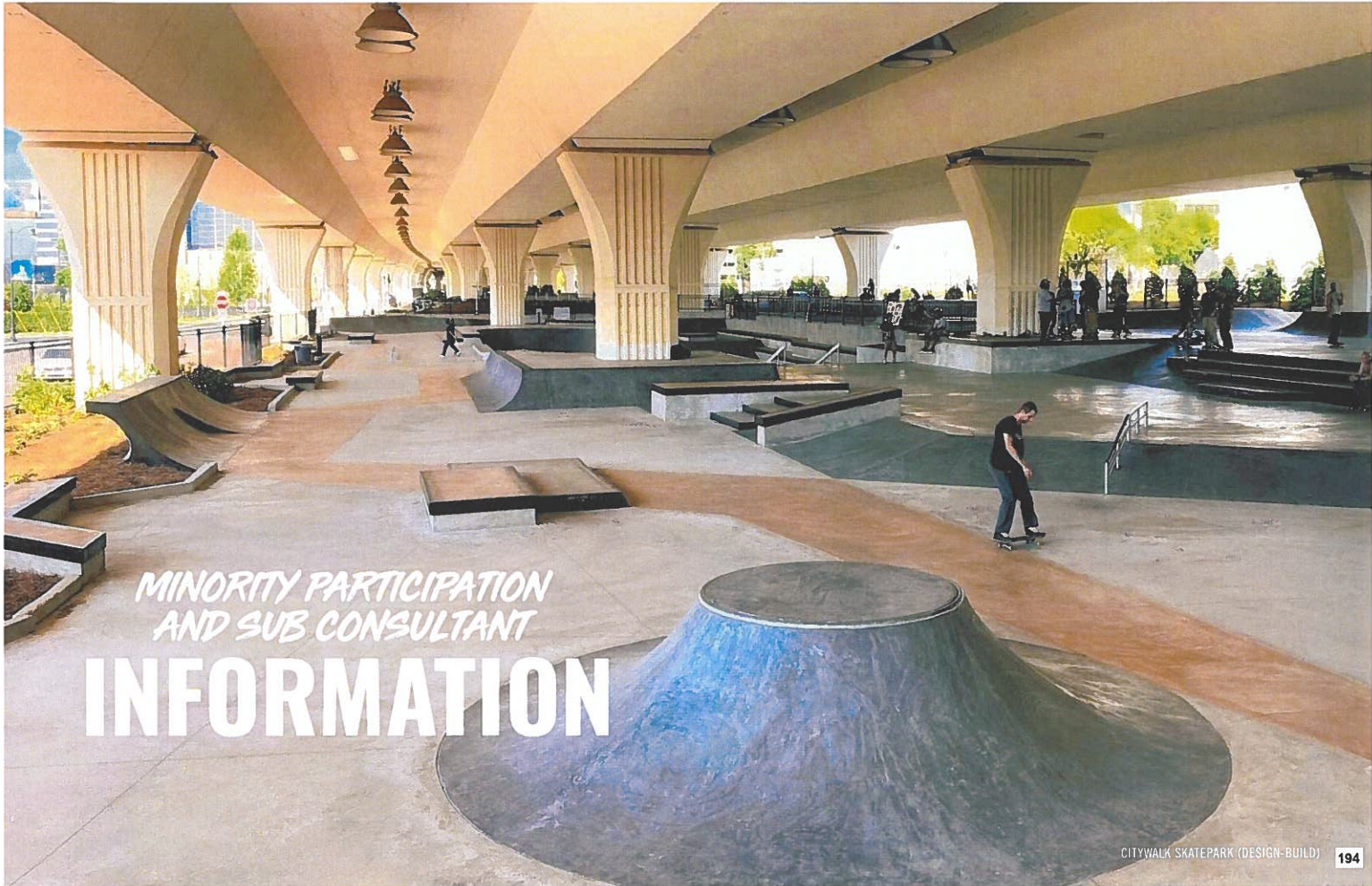

*MINORITY PARTICIPATION
AND SUB CONSULTANT*
INFORMATION



MINORITY PARTICIPATION

New Line Skateparks is not a certified MBE, SBE or a veteran-owned business. However, we're committed to diversity in the workforce and support the use of such firms. We regularly partner with them and other subconsultants with small business status.

As a firm, we embrace an inclusive environment by valuing all individuals and their many diverse backgrounds. Thus, we are better able to deliver high-quality services to our clients, create competitive advantages, and drive market leadership. It's an established United States government and New Line Skateparks policy to provide an equitable and proactive opportunity for minority businesses, small businesses, disadvantaged businesses, women-owned small businesses, and HUBZones to compete for New Line Skateparks subcontracts and purchases consistent with their capabilities, government requirements, and New Line Skateparks' contractual requirements. Our policy is to confirm that small business concerns, including those owned and controlled by socially and economically disadvantaged individuals, will have the maximum practical opportunity to participate in the performance of subcontracts awarded.

New Line Skateparks employs equitable and proactive practices in offering opportunities to small and minority businesses. New Line Skateparks is proud of its past and current efforts in seeking, contracting with, and—more importantly—working with these small businesses. Our corporate history in meeting and exceeding subcontracting goals established in our small business plans is excellent. New Line Skateparks' approach is to actively seek minority businesses, small businesses, disadvantaged businesses, women-owned small businesses, and HUBZones that share our high-quality standards, service, timeliness, and reasonable cost.

SUB CONSULTANT PARTICIPATION

As **Prime Contractor and Lead Designer, New Line Skateparks**, will direct all project action and self-perform all specialized skatepark community consultation, certified design and complex concrete and steel construction works

Joining us once again after a successful collaboration on the *Downtown Panama City Skatepark*, local topographic survey, permitting and stormwater engineering support will be provided by Morgan Hurst and the team at **Dewberry (Panama City)**. Dewberry's extensive past and current work throughout Bay County will provide our team with a strong grasp of local and State permitting requirements and management protocol, excellent site and community context understanding, and full-service Engineering and Site Survey support as needed throughout the project.

Rounding out our group is the trusted team at **Magnum Engineering and HG Engineers**. Well known within the area, Magnum Engineers and HG Engineers will work under our direction as a sub-consultants for the supply of all site geotechnical investigations and electrical engineering/lighting design responsibilities.

All remaining non specialized construction scopes such as bulk earthworks, finishing landscaping, lighting installation etc will be executed under our direction by reputable local Panama City Beach area contractors. All major materials (sub base aggregate, concrete, rebar, lumber, etc.) will also be sourced locally through an internal RFP process.



MAGNUM ENGINEERING INC
GEOTECHNICAL ENGINEERING CONSULTANTS



Morgan Hurst, PE
SENIOR PROJECT MANAGER | STORMWATER/ROADWAY
ENGINEER

Morgan Hurst is responsible for developing various civil design projects. He has extensive experience and is responsible for the design and permitting of various engineering projects for both public and private entities through local, state, and federal regulatory agencies. His primary responsibilities involve Client Management, Project Administration, Public Institutional development, residential development, stormwater management design, drainage basin and hydraulic analysis, utility design, and permitting.

Panama City Skate Park, Panama City, FL, Civil Engineer

Provided engineering, planning, and site design of a skate park in downtown Panama City. The new skate park is a 5,000± SF concrete street skate style park with multiple transitions and elements applicable to skateboarders, in-line skaters, BMX bicyclists, razer scooter riders, and similar recreation users. Tasks included site design, surface grading, stormwater management design, permitting, and construction phase services.

Lynn Haven City Hall, Lynn Haven, FL, Civil Engineer

Provided engineering, planning, and design of a City Hall campus spanning multiple noncontiguous properties. The new building will be the central location for the council chambers, staff office space, and police department for the City of Lynn Haven. The project consisted of a new building, plaza courtyard, onsite parking lot, off-site parking lot and stormwater. Tasks included site design, surface grading, wet detention pond, utility connections, and construction administration services for the construction of a new 16,000 square foot City Hall.

GCSC STEM Building, Panama City, FL, Project Engineer

The project will consist of a ±88,000 square foot STEM building, surface parking facilities, road and sidewalk connections, potable water and wastewater services, drainage conveyance and stormwater management. Our team provided professional services for surveying, planning, engineering, meetings, permitting, and construction phase services.

Bay District Schools, Haney New Classroom Building, Bay County, FL, Project Manager

Dewberry was part of the team selected to assist with re-building schools that were damaged during Hurricane Michael. For the Tom P. Haney Technical Center, Dewberry provided civil engineering services including surveying, engineering and permitting, and construction phase services. Tasks included preparing a topographic survey, developing the overall site plan including parking lot configuration and traffic circulation, ADA accessibility, and determining utility service connection locations; preparing construction engineering plans; performing stormwater modeling and treatment; and coordinating construction meetings, inspections, and certifications.

- **OFFICE ADDRESS**
203 Aberdeen Parkway
Panama City FL 32405
- **EDUCATION**
BS • Environmental
Engineering • University of
Florida
- **REGISTRATIONS**
PE - FL #60813
- **YEARS OF EXPERIENCE**
Dewberry • 6
Prior • 19



Jonathan Gibson, PSM
SURVEY DEPARTMENT MANAGER | SURVEYOR

Jonathan Gibson has extensive experience in all aspects of land surveying, including commercial and residential development projects as well as specific purpose and construction layout services. He has experience in providing certified ALTA/ACSM surveys which include review of title work and land use and zoning documents.

Lynn Haven City Hall, Lynn Haven, FL, Lead Surveyor

Provided survey services for the City Hall campus spanning multiple noncontiguous properties. The new building will be the central location for the council chambers, staff office space, and police department for the City of Lynn Haven. The project consisted boundary and topographic survey of 7.96± acres.

Breakfast Point East Hotel, Bay County, FL, Lead Surveyor

Provided survey services for the Breakfast Point East Hotel on approximately 7.27± acres located at 47 Chip Seal Pkwy, Panama City Beach. The project consisted boundary and topographic survey.

Panama City Beach CRA Contract, Panama City Beach, FL, Lead Surveyor

Leading survey related tasks for City of Panama City Beach CRA planned projects. The Front Beach Road CRA Segments 4.1 and 4.2 projects is a 3.2± mile roadway project located in Panama City Beach, Florida. This project consisted of route topographic and right of way surveying to aid in civil engineering design.

Bay District Schools, Haney New Classroom Building, Bay County, FL, Lead Surveyor

Leading survey related tasks for a new building and all supporting infrastructure on the Haney school campus. Tasks performed for this project include topographic survey for existing surface improvements and underground utilities.

Thomas Drive, Panama City Beach, FL, Lead Surveyor

The Thomas Drive Resurfacing project is a 3.1± mile roadway project located in Panama City Beach, Florida. This project consisted of route topographic and right of way surveying to aid in civil engineering design.

Harbour Green Apartments, Panama City Beach, FL, Lead Surveyor

Harbour Green Apartments is a 26 building multi-family apartment complex on approximately 19.5 acres located at 7120 Patronis Drive, Panama City Beach, Florida. Jonathan served as lead Professional Land Surveyor for an ALTA/ACSM survey.

College Station Development, Bay County, FL, Lead Surveyor

College Station is a multi-phase 401.5 acre residential development in Bay County, Florida. Dewberry is providing pre-design services for the College Station residential development area, including surveying and environmental services.

- **OFFICE ADDRESS**
03 Aberdeen Parkway
Panama City FL 32405
- **EDUCATION**
BS • Geomatics • Troy
University
- **REGISTRATIONS**
FL • Professional Surveyor
and Mapper #LS6851
- **YEARS OF EXPERIENCE**
Dewberry • 4
Prior • 13



DANIEL WHITE

P.E. LEED AP (BD+C)

Project Manager
Electrical Engineer
Energy Engineer
Business Owner

17 Years Experience ... 16 Years with –G Engineers

EDUCATION

May 2006
BSEE

FOUNDATION:

Bachelor of Science in Electrical Engineering - Auburn University

January 2012
PE

PROFESSIONAL LICENSES:

Professional Engineering license in Florida - 73790
Licensed in AL and NC

April 2011
LEED

INDUSTRY FOCUS:

Accredited Professional for Building Design and Construction

COMPANY ROLE

Dan has 17 years of degreed consulting engineering and seven years of experience working for a consulting engineer company prior to obtaining his degree. He leads the engineering for architectural design services. He has field experience as a project engineer surveying power systems on military projects across the continental United States and internationally in Germany and Japan. His design experience includes military, schools, multi-family housing, airport terminals, churches, parks, and commercial buildings.

EXPERIENCE

CITY OF LYNN HAVEN SPORTSPLEX FACILITY

HG provided electrical engineering construction documents for the approximately 26, 491 sq ft facility including two full basketball courts, concessions, administration, equipment room, computer lab, aerobics/exercise, restrooms, and supporting spaces.

ST. ANDREWS STATE PARK RV

HG provided electrical engineering construction documents for the upgrade of 174 camp sites from 30amps to 50amps, including new electrical infrastructure. Design included power utility coordination, site electrical units, lift station power, and repowering restroom buildings.

TRUST FOR PUBLIC LAND-4 PARKS

HG provided electrical engineering construction documents for the four parks: Island Park View \$2M/2018, Innerarity Point Park \$4.3M/2019, Captain Leonard Destin Park \$5M/2021, Lynn Haven Bayou Park and Preserve \$11.5M/2021 - Total Value \$22.8M

MEXICO BEACH TWO NEW PAVILIONS

HG provided the electrical engineering construction documents for two pavilions, Canal Park pavilion and Boat Ramp pavilion and fish cleaning station. Design also included wildlife lighting, site utility power, lighting, power, and HVAC power.

HG ENGINEERS

142 Eglin Parkway SE
FORT WALTON BEACH
Florida 32548

621 N. Tyndall Parkway, Unit C
PANAMA CITY
Florida 32404

4286 Woodbine Rd, Unit D
PACE
Florida 32571

AFFILIATIONS

Florida Engineering Society

National Society of Professional Engineers

Society of American Military Engineers

U.S. Green Building Council

SKILLS

Power Systems // Energy
Lighting // Fire Alarm Systems
Grid-Tie Photovoltaic Power // Power
Metering // RF // ESS
CCTV // ACS



James T. Vickers PE

Geotechnical Engineer (Magnum Engineering, Inc.)

Mr. Vickers is the Senior Geotechnical Engineer/ Principal Consultant/ Owner for Magnum Engineering, Inc. located in Lynn Haven, Florida. Responsible for all aspects of Geotechnical Engineering Consulting, Project Management, and Coordination; including site inspections, drilling coordination, site preparation recommendations, pavement recommendations, stormwater recommendations, and foundation recommendations, (both deep and shallow).

RECENT RELEVANT EXPERIENCE (CITY OF PANAMA CITY BEACH, FL)

Skate Park PCB – Sports Park – Panama City Beach (2020)

Breakfast Point Subdivision – Panama City Beach (2019 to 2023)

N. Clara Avenue – Panama City Beach (2016)

JCF Living – N. Clara Avenue – Panama City Beach (2020 - 2021)

Moyfan Road North Extension - Panama City Beach (2021)

Panama City Beach City Hall – Panama City Beach (2022)

Numerous commercial sites pavement and stormwater recommendations

Numerous commercial and residential foundation recommendations

EDUCATION:

BS, Civil Engineering, Florida State University

REGISTRATIONS:

Florida Registered Professional Engineer
56813
Florida Certified General Contractor
CGC1510945
Florida Class C Drinking Water Treatment
Plant Operator 0022070

YEARS OF EXPERIENCE:

Magnum Engineering, Inc. : 17

Prior : 13

*FINANCIAL RESOURCES
AND LEGAL*
INFORMATION

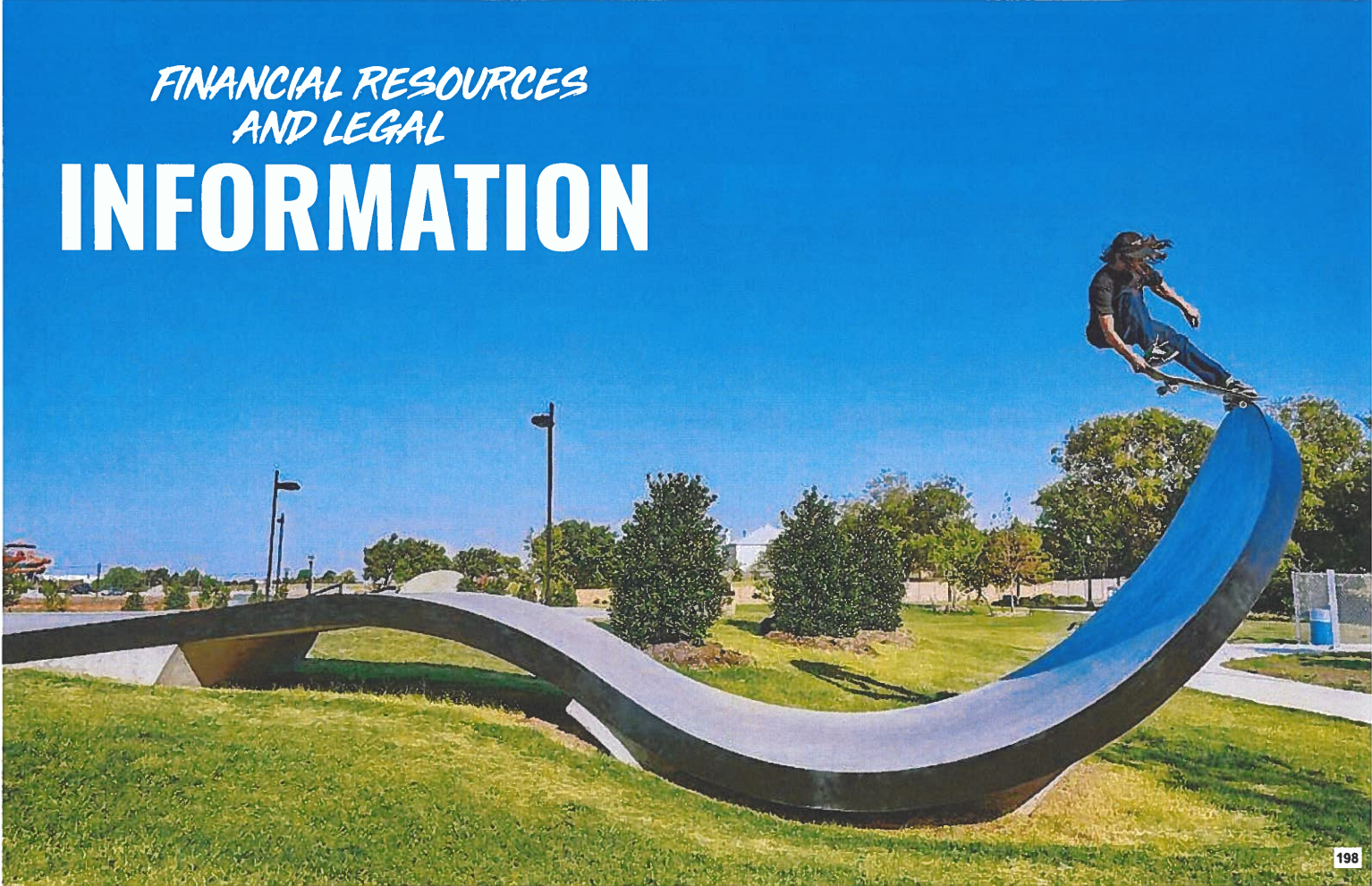



FINANCIAL RESOURCES

LEGAL PROCEEDINGS AND PERFORMANCE

New Line Skateparks FL, Inc (including related companies and subsidiaries) is in excellent financial standing and has a sterling record of financial performance proven through more than 23 years of continuous execution of large-scale municipal skatepark projects in multiple jurisdictions throughout Florida and across North America. New Line Skateparks is not currently involved a Bankruptcy proceeding and has never had a Bankruptcy Petition filed since its original incorporation (February 2001). See Surety Qualification Letter from our bonding provider below.

New Line Skateparks, FL Inc has never paid liquidated damages or been terminated for default. New Line Skateparks FL, Inc also has had no Arbitrations, Lawsuits, or Other Proceedings in the last 5 years. Our firm (and subsidiaries) has never had a Bankruptcy Petition filed nor a contract that was terminated by another party. Finally the New Line Skateparks group of companies has never had a bond called (use of bonding) in the history of our operations (23 + years).

Kyle Dion
President - New Line Skateparks FL, Inc

Date: February 29th, 2024

To: City of Panama City Beach
17007 Panama City Beach Parkway
Panama City Beach, FL 32413



Re: **CONTRACTOR:** NEW LINE SKATEPARKS FL, INC.
PROJECT: PCB24-25 RFQ SKATE PARK DESIGN-BUILD SERVICES

Dear All:

We are the Surety for New Line Skateparks FL, Inc. They have demonstrated to us in the past an ability to complete their projects in accordance with the conditions of their contracts and we have no hesitation in recommending their services to you.

Our client wishes to be prequalified as a bidder on the captioned project. New Line Skateparks FL, Inc has completed single projects in excess of \$2,500,000 and have maintained an aggregate work program in excess of \$10,000,000 though these limits may be increased at the sole discretion of the Surety. Based on the limited information available at this time and subject to our assessment of the project and our client's work program at the time of tender, we do not anticipate a problem in supporting the captioned project and supplying the requisite bonds, if asked to do so. However, the execution of any bonds will be subject to an assessment of the final contract terms, conditions, financing and bond forms by our client and ourselves.

Liberty Mutual Insurance Company is rated A, Stable by A.M. Best rating agency.

If we can provide any further assurances or assistance, please don't hesitate to call upon us.

Yours truly,

LIBERTY MUTUAL INSURANCE COMPANY

Gilbert Kimani, CPA, CA
Attorney-In-Fact

LIBERTY MUTUAL INSURANCE COMPANY
181 Bay Street, Suite 900, Brookfield Place, Toronto, Ontario M5J 2T3



CITY OF PANAMA CITY BEACH

February 22, 2023

ADDENDUM NO. 1

PCB24-25 RFQ SKATE PARK DESIGN-BUILD SERVICES

Questions:

1. What is the budget for this project?

A. The City's original allocation for this project was \$400,000.00 –the budget has been amended to \$1.4 million, as a result of the City Council Meeting held on February 22, 2024.

Revision:

A pre-proposal conference and site visit will be held for interested parties on **Tuesday, February 27, 2024 at 11:00AM CDT**, in the Panama City Beach Council Chambers, 17007 Panama City Beach, Florida 32413. Attendance of this meeting is optional, ~~please note however, virtual participation is not available for this event.~~

**Virtual participation of this conference will be available via the following link:
Please email purchasing@pcbfl.gov with your intention to attend.**

Join Zoom Meeting

<https://us06web.zoom.us/j/8211759910?pwd=WG84REN1UG1STDhuaVZZb0IScDI2dz09>

Meeting ID: 821 175 9910

Passcode: PCBCS2020

One tap mobile

+13052241968,,8211759910#,,,,*420587769# US

+13017158592,,8211759910#,,,,*420587769# US (Washington DC)

PCB24-25 RFQ – SKATE PARK DESIGN-BUILD SERVICES

Dial by your location

- +1 305 224 1968 US
- +1 301 715 8592 US (Washington DC)
- +1 309 205 3325 US
- +1 312 626 6799 US (Chicago)
- +1 646 931 3860 US
- +1 929 205 6099 US (New York)
- +1 689 278 1000 US
- +1 719 359 4580 US
- +1 253 205 0468 US
- +1 253 215 8782 US (Tacoma)
- +1 346 248 7799 US (Houston)
- +1 360 209 5623 US
- +1 386 347 5053 US
- +1 507 473 4847 US
- +1 564 217 2000 US
- +1 669 444 9171 US
- +1 669 900 6833 US (San Jose)

Meeting ID: 821 175 9910

Passcode: 420587769

Find your local number: <https://us06web.zoom.us/j/kjC5nsLy>



CITY OF PANAMA CITY BEACH

March 1, 2023

ADDENDUM NO. 2

**PCB24-25 RFQ
SKATE PARK DESIGN-BUILD SERVICES**

Questions:

1. Where can we find the reference form?
A. The reference form is attached to this addendum.
2. Can we get access to CAD drawings?
A. Please use the following link to access the CAD drawings.

[Skate Park CAD](#)

REFERENCES FORM

Bidder shall provide a minimum of three references, for which they are currently providing a similar service/commodity of size and scope for Government agencies.

1. Client: _____ Contact: _____

Job Name: _____

Job Start Date: _____ Job Completion Date: _____

2. Client: _____ Contact: _____

Job Name: _____

Job Start Date: _____ Job Completion Date: _____

3. Client: _____ Contact: _____

Job Name: _____

Job Start Date: _____ Job Completion Date: _____

4. Client: _____ Contact: _____

Job Name: _____

Job Start Date: _____ Job Completion Date: _____

5. Client: _____ Contact: _____

Job Name: _____

Job Start Date: _____ Job Completion Date: _____



CITY OF PANAMA CITY BEACH

March 7, 2024

ADDENDUM NO. 3

**PCB24-25 RFQ
SKATE PARK DESIGN-BUILD SERVICES**

Questions:

1. Can you provide the status of the other improvements for the connector road, and other amenities, such as the pavilion? Where are they in the stormwater permitting process and what is the percentage complete?

A. The connector road construction is 60% complete. Anticipated substantial completion in May 2024. The Miracle League Pavilion and Restroom, and skate pad design is currently in the design process. Design is anticipated to be completed by July 15, 2024.

The connector road project we are repairing/replacing an existing roadway so stormwater permitting was not required. Additional parking areas were handled with adjacent swales and the engineer of record handled stormwater permitting for those added areas. The skate park has an existing stormwater facility to the north that should not be disturbed during construction and the pavilion runoff is captured through a system that goes to an existing stormwater pond.

The stormwater masterplan for the entire park is on the march 28, 2024 agenda for approval to move forward with the design for all proposed future amenities.

PCB24-25

Skate Park Design-Build Services

Per the RFQ, scoring for each responding firm was determined using the assigned points for each of the referenced criteria elements:

CRITERIA ELEMENTS	POINTS AVAILABLE		ECSC	New Line Skate Parks	Spohn Ranch
	PER PERSON	TOTAL			
Firm Qualifications and Experience	25	125	67.50	110.00	87.50
Organizational Profile and Design-Build Team Qualifications	25	125	70.00	97.50	90.00
Firm's Approach to Scope of Work	40	200	109.00	176.00	112.00
Past Performance & References	10	50	33.00	39.00	34.00
	100	500	279.50	422.50	323.50
Ranking based upon overall scores	1 New Line Skate Parks 2 Spohn Ranch 3 ECSC		3	1	2